

Thank you for using eradoc, a platform to publish electronic copies of the Rothamsted Documents. Your requested document has been scanned from original documents. If you find this document is not readable, or you suspect there are some problems, please let us know and we will correct that.

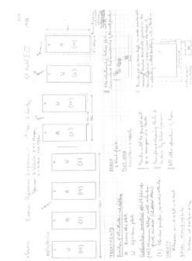

ROTHAMSTED
RESEARCH

Collection of Plans for the Woburn Erosion Reference Experiment



[Full Table of Content](#)

Woburn Erosion Reference Experiment 1989

Rothamsted Research

Rothamsted Research (1988-1998) *Woburn Erosion Reference Experiment 1989* ; Collection Of Plans For The Woburn Erosion Reference Experiment, pp 2 - 2

206

Woburn

Erosion Reference Experiment 2nd Year Potatoes

St Hill II/III

1989

Sponsors: R. Webster, R.P.C. Morgan, R.F. Richon, P.R. Styles

89/W/RN/20

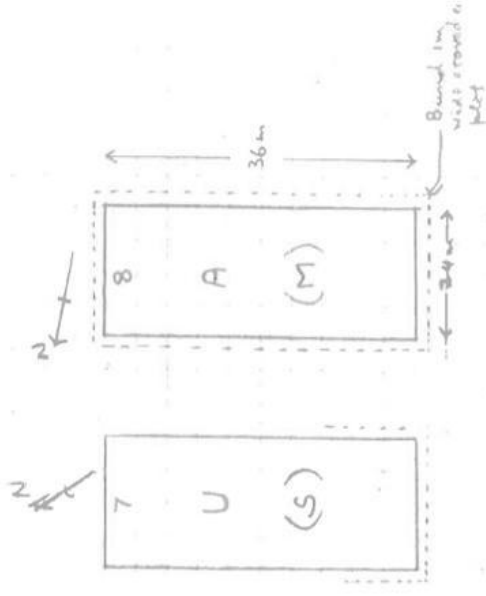
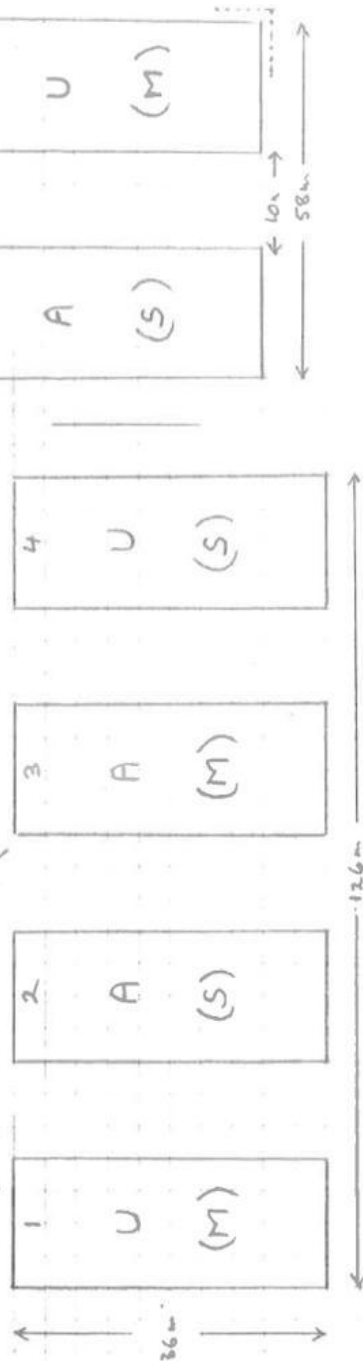

TREATMENTS

Direction of all cultivations and plantings

- A Across the plots
- U Up & down plots

Cultivation practice

- (M) Minimum tillage: 1988 barley straw chopped & tined into 10cm. 1989 potato haulm pulverized & retained
- (S) Standard practice: 1988 barley straw baled & removed. 1989 potato haulm removed.

VARIETY

Estima, planted 10 May
 BASAL MANURING 165 kg
 (13:13:20) at 18.00 kg

DESIGN

2 block of 2x2

PLOT AREA

$2.4 \text{ m} \times 36 \text{ m} = 0.0864 \text{ ha}$

The relationships between plots as shown above but as indicated by the North points:-

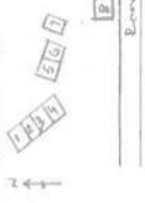

- Tanks will be pumped out to a main gun or a tanker
- Pumping & cleaning tanks to be done by Silval & Jensen
- All other operations by Farm
- Basil sprayed at 5 kg to seedbed

Bunds are 10-30cm high, 1m wide, erected after planting, tractor-traversable, graded on the down-slope end 1:20 across the slope to collecting outlet emptying into a tank:-

