

Thank you for using eradoc, a platform to publish electronic copies of the Rothamsted Documents. Your requested document has been scanned from original documents. If you find this document is not readable, or you suspect there are some problems, please let us know and we will correct that.



ROTHAMSTED  
RESEARCH

# Collection of Plans for the Woburn Long-term Liming Experiment



[Full Table of Content](#)

## Woburn Long-term Liming Experiment 1993

### Rothamsted Research

Rothamsted Research (1962 - 1997) *Woburn Long-term Liming Experiment 1993* ; Collection Of Plans For The Woburn Long-Term Liming Experiment, pp 27 - 27

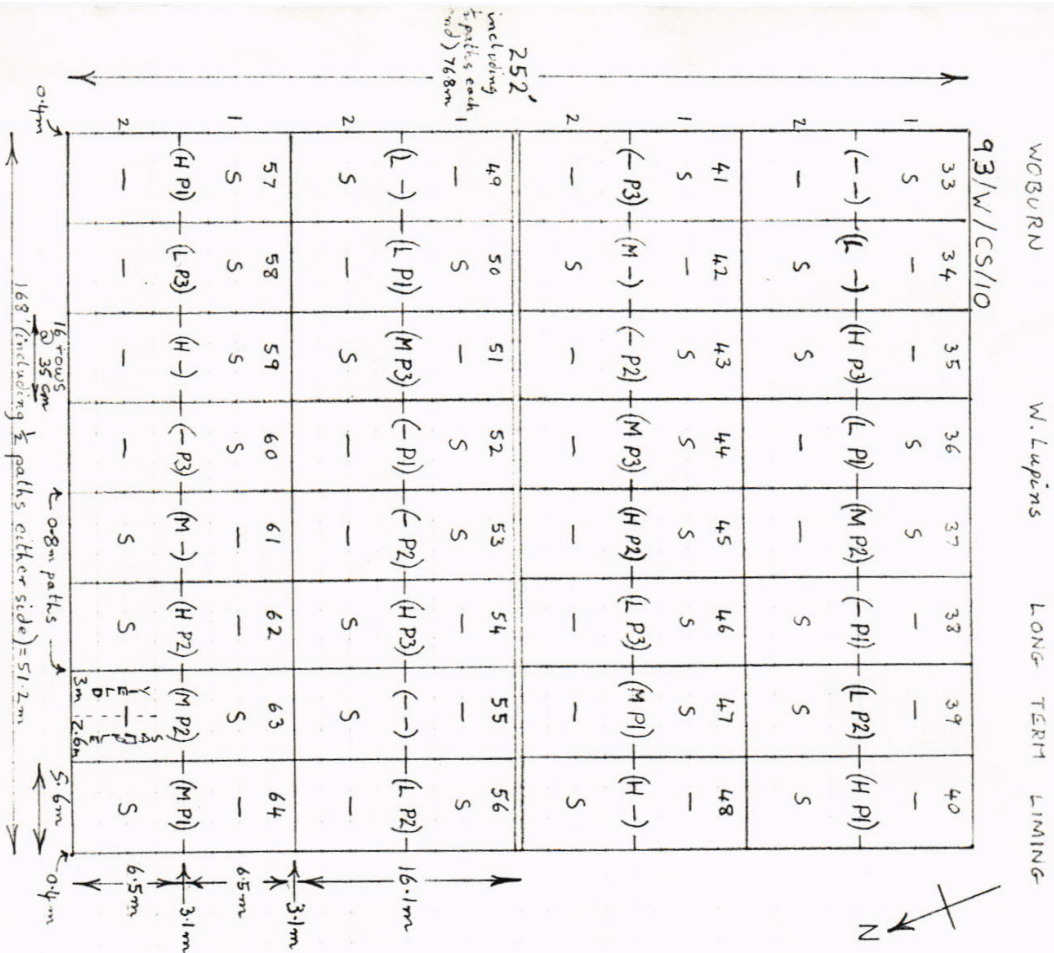

32nd Year STACKYARD Series C 1993  
 Sponsors: S.P. Mc Grath, P.B. Barralough, G.F. J. Milford, J.M. Day

TREATMENTS  
 Residual effects of previous rates of lime  
 (total applied 1962-1978, 1981 & 1982) t ha<sup>-1</sup>  
 (-) None  
 (L) 9  
 (M) 25.5  
 (H) 45.5.  
 Residual effects of previous rates of P applied 1962-88, rates varied with crops years  
 (-)  
 (P1)  
 (P2)  
 (P3)  
 Sulphur in 1993 (cumulative to 1991 & 1992)  
 - None  
 S calcium sulphate @ 30 kg S ha<sup>-1</sup> by hand

BASAL MANURING  
 None

VARIETY  
 CH304/70 Sown @ 1 kg ha<sup>-1</sup> on

DESIGN  
 2 blocks of 16 plots split into 2

PLOT AREA  
 Whole plot: 5.6m x 16.1m = 0.009 ha

|| All agrochemicals to be cleared by sponsor  
 || All operations by Farm.  
 || Sponsors supply inoculated seed