

Thank you for using eradoc, a platform to publish electronic copies of the Rothamsted Documents. Your requested document has been scanned from original documents. If you find this document is not readable, or you suspect there are some problems, please let us know and we will correct that.

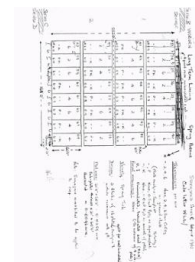

ROTHAMSTED
RESEARCH

Collection of Plans for the Woburn Long-term Liming Experiment



[Full Table of Content](#)

Woburn Long-term Liming Experiment 1990

Rothamsted Research

Rothamsted Research (1962 - 1997) *Woburn Long-term Liming Experiment 1990* ; Collection Of Plans For The Woburn Long-Term Liming Experiment, pp 24 - 24

WOBURN

LONG-TERM LIMING

S. Beams

29th year STACKYARD series C 1990

Sponsors: S.P.H., G. Rath, J. McEwan, D. Fryeman

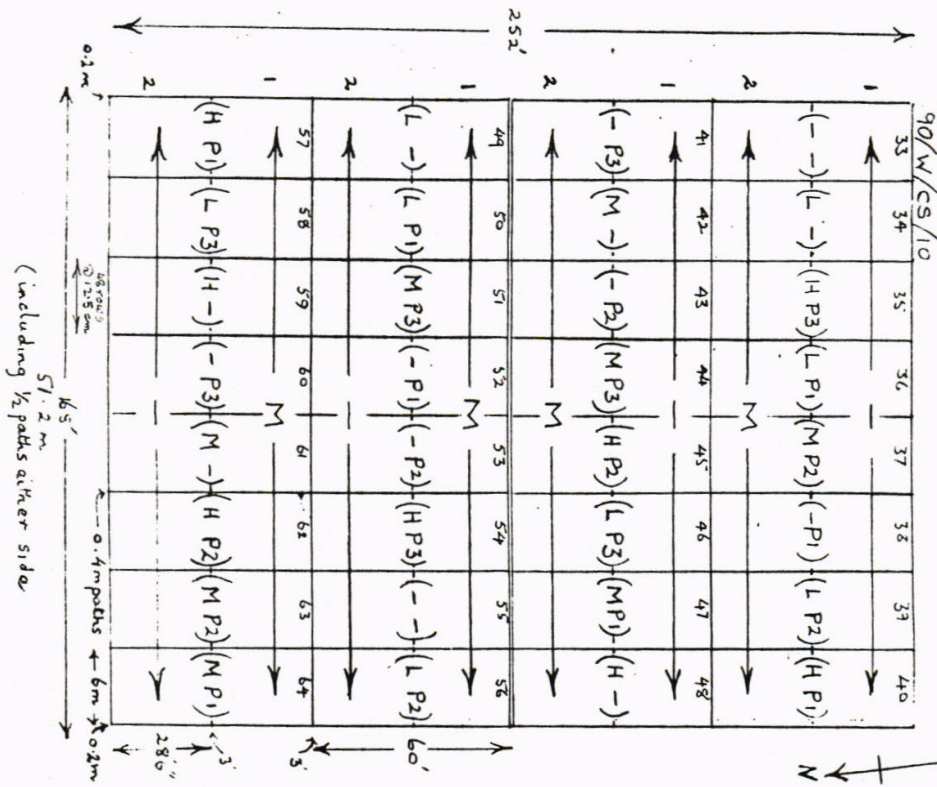

90/W/CS/10

TREATMENTS

Residual effects of previous rates of lime
(total applied 1962-1978, 1981 & 1982)

- (-) None
- (L) 9
- (M) 25.5
- (H) 45.5

Residual effects of previous rates of P applied 1962-88, rates varied with crops/year

- (-) None
- (P1) 9
- (P2) 25.5
- (P3) 45.5

Manganese sprays in 1990 cumulative to previous applications

M None
Vitel' at 3.0L at 4 leaf stage + 1/2L just before flowering
(applied by sprayer across strips of subplots and to travel also over - subplots on each occasion to equalize wheelings).

BASAL MANURING

None

VARIETY Sown @ 250 kg/ha on 5 March

DESIGN

2 block of 16 plots, split into 2.

PLOT AREA

6m x 60' = 0.0110 ha
Harvest 22 rows @ 12.5cm x 28'6" = 0.0025 ha

Plants at 1.8 kg s./ha & weeded

DILLING

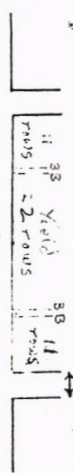

Vitel' supplied by S.P.H.
All operations by Far