

Thank you for using eradoc, a platform to publish electronic copies of the Rothamsted Documents. Your requested document has been scanned from original documents. If you find this document is not readable, or you suspect there are some problems, please let us know and we will correct that.



ROTHAMSTED  
RESEARCH

# Collection of Plans for the Fosters Ley-arable Experiment



[Full Table of Content](#)

## Fosters Ley-arable 1970-79

### Rothamsted Research

Rothamsted Research (1949-1990) *Fosters Ley-arable 1970-79* ; Collection Of Plans For The Fosters Ley-Arable Experiment, pp 22 - 31

Rothamsted LEY - ARABLE 22<sup>nd</sup> year 70/R/RN/2 FOSTERS 1970

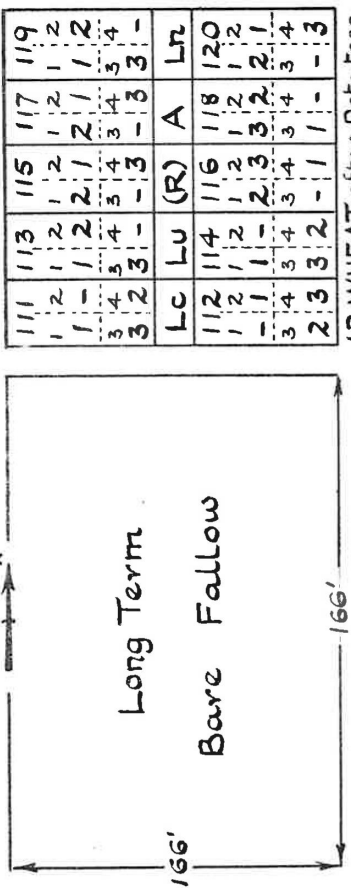

091	093	095	097	099	101	103	105	107	109
1 2	1 2	1 2	1 2	1 2	1 2	1 2	1 2	1 2	1 2
3 4	3 4	3 4	3 4	3 4	3 4	3 4	3 4	3 4	3 4
2 1	1	3	3	3	2	3	4	1	4
Ln	Lu	Lc	A	(R)	Lc	A	Ln	Lu	(R)
092	094	096	098	100	102	104	106	108	110
1 2	1 2	1 2	1 2	1 2	1 2	1 2	1 2	1 2	1 2
3 4	3 4	3 4	3 4	3 4	3 4	3 4	3 4	3 4	3 4
1	2	1	1	3	3	4	1	2	2
3	4	3	4	3	4	3	4	3	2
3	2	3	2	2	3	4	1	2	2
Ln	Lu	Lc	A	(R)	Lc	A	Ln	Lu	(R)

10. WHEAT after Potatoes 11. WHEAT 5th test crop

051	053	055	057	059
1 2	1 2	1 2	1 2	1 2
2 4	2 3	4 3	3 4	3 1
Lu	(R)	Lc	Ln	A
052	054	056	058	060
1 2	1 2	1 2	1 2	1 2
1 3	4 1	2 1	1 2	2 4
Lu	(R)	Lc	Ln	A

12. WHEAT after Potatoes

061	063	065	067	069
1 2	1 2	1 2	1 2	1 2
3 2	4 2	1 2	1 3	1 3
Lc	Ln	Lu	(R)	A
071	073	075	077	079
1 2	1 2	1 2	1 2	1 2
3 4	3 4	3 4	3 4	3 4
3 2	3 2	1 2	3 2	3
Ln	Lc	A	(R)	Lu
072	074	076	078	080
1 2	1 2	1 2	1 2	1 2
3 4	3 4	3 4	3 4	3 4
2 1	1 2	1 2	3 3	3
2	1	1	2	3
Ln	Lc	A	(R)	Lu

7. WHEAT 6th test crop 8. BARLEY after Wheat 9. BARLEY after Wheat

021	023	025	027	029
1 2	1 2	1 2	1 2	1 2
1	2	1	2	1
Lu	Ln	B <sup>1/2</sup>	Lc	
031	033	035	037	039
1 2	1 2	1 2	1 2	1 2
2 3	3 4	2 3	3 4	3 4
Ln	Lu	Lc	(R)	A
041	043	045	047	049
1 2	1 2	1 2	1 2	1 2
2 4	2 3	2 4	2 4	3 2
Lu	Lc	Ln	(R)	A

6. WHEAT 5th test crop

001	003	005	007	009
1 2	1 2	1 2	1 2	1 2
1	2	1	2	1
Lc	B <sup>1/2</sup>	Lu		Ln
002	004	006	008	010
1 2	1 2	1 2	1 2	1 2
3	4	3	4	3
Ln	Lu	Lc	(R)	A

Sowing dates  
Wheat - Jess Cambier  
at 180lb : 16 Oct 1969  
Barley - Julia at 140lb  
per acre : 20 May 1970

1. Treatment Crops 1st year  
2. POTATOES 1st Test Crop  
3. Treatment Crops 1st year  
4. POTATOES 1st Test Crop  
5. WHEAT 6th test crop

1971

1971  
486

71/R/RN/2

23rd year

LEY - ARABLE

Rothamsted

10  
1971  
FOSTERS  
1971

N Rates, per acre  
W.Wheat, 2nd Test Crop

None  
1 0.4 cwt N  
2 0.8 cwt N  
3 1.2 cwt N

Barley, 3rd Test Crop

None  
1 0.4 cwt N  
2 0.7 cwt N  
3 1.0 cwt N

091 1 2 2 3 3 4 - 1	093 1 2 2 3 3 4 - 1	095 1 2 2 3 3 4 - 1	097 1 2 2 3 3 4 - 1	099 1 2 2 3 3 4 - 1	101 1 2 2 1 3 4	103 1 2 2 3 3 4	105 1 2 2 4 3 1	107 1 2 2 4 3 1	109 1 2 2 4 3 1
Lr	Lr	Lr	Lr	Lr	Lc	Lc	Lc	Lc	Lr

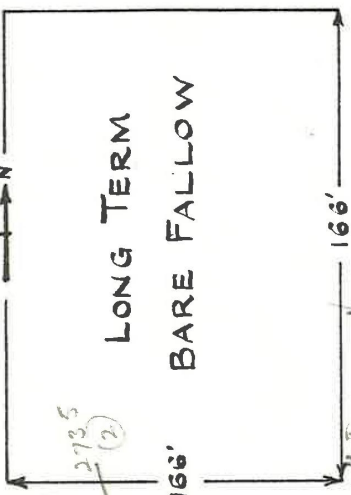

10. BARLEY after Wheat 11. WHEAT 4th cereal

061 1 2 3:2	063 1 2 4:2	065 1 2 1:2	067 1 2 1:3	069 1 2 1:3	071 1 2 4:3	073 1 2 4:1	075 1 2 1:3	077 1 2 2:1	079 1 2 1:2
Lc	Lr	Lu	R5	A	Lr	Lc	A	R8	Lu

12. BARLEY after Wheat

081 1 2 3:4	083 1 2 1:4	085 1 2 2:3	087 1 2 3:4	089 1 2 1:2
R6	Lr	Lc	A	Lu

W.Wheat, 3rd, 4th, 5th Cereal

1 0.6 cwt N  
2 1.0 cwt N  
3 1.4 cwt N  
4 1.8 cwt N

N as "Nitro-Chalk" 2:1

Varieties  
W.Wheat: Joss Cambiey 5-6 Oct 1970  
Barley: Julia 25 Feb 1971

R3, 4, 5, 8, 9 1st arable crop in 1962, 64, 65, 68, 69

6. WHEAT 4th cereal

051 1 2 2:4	053 1 2 2:3	055 1 2 4:3	057 1 2 3:4	059 1 2 3:1
Lu	R9	Lc	Lr	A

7. WHEAT 5th cereal

062 1 2 4:1	064 1 2 1:3	066 1 2 3:4	068 1 2 4:2	070 1 2 4:2
Lc	Lr	Lu	R5	A

1. Treatment Crops 2nd year

001 1 2 F.D	003 1 2 R	005 1 2 R.C	007 1 2 Lr	009 1 2 Lr
Lc	H	Lu	Lu	Lr

2. WHEAT after Potatoes

011 1 2 3:2	013 1 2 - 1	015 1 2 - 1	017 1 2 - 1	019 1 2 - 1
Lr	Lr	R4	A4	Lc2

3. Treatment Crops 2nd year

021 1 2 Lu	023 1 2 Lu	025 1 2 H	027 1 2 Lc	029 1 2 R
Lc	Lr	H	Lc	R

4. WHEAT after Potatoes

002 1 2 F.D	004 1 2 F.D	006 1 2 Lu	008 1 2 Lr	010 1 2 Lr
Lc	H	Lu	Lr	Lr

5. WHEAT after Potatoes

022 1 2 Lu	024 1 2 Lu	026 1 2 H	028 1 2 Lc	030 1 2 R
Lc	Lr	H	Lc	R

8. WHEAT 3rd cereal

031 1 2 3:4	033 1 2 2:1	035 1 2 - 1	037 1 2 2:3	039 1 2 - 3
Lr	Lu	Lc	R4	A4

9. WHEAT 3rd cereal

041 1 2 2:4	043 1 2 2:3	045 1 2 2:4	047 1 2 2:4	049 1 2 3:2
Lu	Lc	Lr	R5	A

10. WHEAT 4th cereal

042 1 2 3:1	044 1 2 4:1	046 1 2 1:3	048 1 2 3:1	050 1 2 4:1
Lc	Lr	Lr	R5	A

11. WHEAT 5th cereal

082 1 2 1:2	084 1 2 2:3	086 1 2 4:1	088 1 2 1:2	090 1 2 3:4
R6	Lr	Lc	A	Lu

1, Treatment Crops 2nd year  
2, WHEAT after Potatoes  
3, Treatment Crops 2nd year  
4, WHEAT after Potatoes  
5, WHEAT 5th cereal

Rothamsted LEY - ARABLE 24th year 72/R/RN/2 FOSTERS 1972 10

10 WHEAT 3rd Cereal. 11 WHEAT 5th Cereal

091 1 2	093 1 2	095 1 2	097 1 2	099 1 2	101 1 2	103 1 2	105 1 2	107 1 2	109 1 2
4 3	4 2	1 4	3 2	2 4	2 1	3 4	1 2	4 1	4 3
5	1	2	4	5	2	4	5	1	5
Ln	Lu	Lc	A	R <sup>3</sup>	Lc	A	Ln	Lu	R <sup>9</sup>
092 1 2	094 1 2	096 1 2	098 1 2	100 1 2	102 1 2	104 1 2	106 1 2	108 1 2	110 1 2
2 1	3 1	3 2	4 1	3 1	3 4	1 2	4 3	3 2	2 1

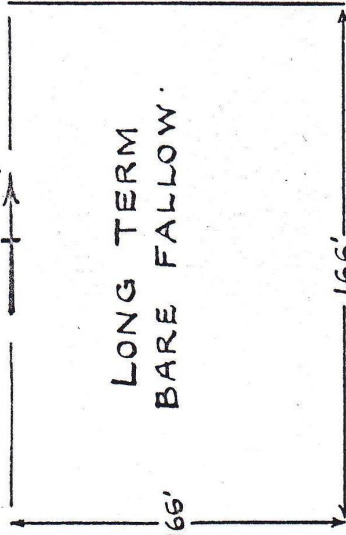

12 WHEAT 3rd Cereal

111 1 2	113 1 2	115 1 2	117 1 2	119 1 2
4 1	1 2	1 4	1 3	1 3
2	1	5	4	5
Lc	Lu	R <sup>3</sup>	A	Ln
112 1 2	114 1 2	116 1 2	118 1 2	120 1 2
2 3	4 3	2 3	2 4	2 4

10 WHEAT 3rd Cereal. 11 WHEAT 5th Cereal

6 WHEAT 5th Cereal

051 1 2	053 1 2	055 1 2	057 1 2	059 1 2
2 4	2 3	4 3	3 4	3 1
1	5	2	3	4
Lu	R <sup>9</sup>	Lc	Ln	A
052 1 2	054 1 2	056 1 2	058 1 2	060 1 2
1 3	4 1	2 1	1 2	2 4

R 3.4.5.8.9 1st arable crop 1963, 64, 65, 68, 69.

7 WHEAT 6th Cereal 8 WHEAT 4th Cereal 9 WHEAT 4th Cereal

061 1 2	063 1 2	065 1 2	067 1 2	069 1 2	071 1 2	073 1 2	075 1 2	077 1 2	079 1 2
3 2	4 2	1 2	1 3	1 3	4 3	4 1	1 3	2 1	1 2
2	3	1	5	4	3	2	4	5	1
Lc	Ln	Lu	R <sup>6</sup>	A	Ln	Lc	A	R <sup>8</sup>	Lu
062 1 2	064 1 2	066 1 2	068 1 2	070 1 2	072 1 2	074 1 2	076 1 2	078 1 2	080 1 2
4 1	1 3	3 4	4 2	4 2	2 1	3 2	4 2	4 3	3 4

6 WHEAT 5th Cereal

1 Treatment Crops 2 BARLEY (sown 15 Mar) after Wheat 3 Treatment Crops 4 BARLEY after Wheat 5 WHEAT 6th Cereal

001 1 2	003 1 2	005 1 2	007 1 2	009 1 2	011 1 2	013 1 2	015 1 2	017 1 2	019 1 2
			R	n.c	1	2	3	4	3
					3	4	3	2	1
Lc	Sb	Lu	Lu	Ln	R <sup>4</sup>	A	Lc	Ln	Lu
002 1 2	004 1 2	006 1 2	008 1 2	010 1 2	012 1 2	014 1 2	016 1 2	018 1 2	020 1 2
					3	2	1	3	4
					3	4	3	2	1

3 Treatment Crops 4 BARLEY after Wheat 5 WHEAT 6th Cereal

021 1 2	023 1 2	025 1 2	027 1 2	029 1 2	031 1 2	033 1 2	035 1 2	037 1 2	039 1 2
				R	Ln	Lu	Lc	R <sup>4</sup>	A
				c.n	3	4	3	2	3
Lu	Ln	Sb	Lc	Ln	Lu	Lc	R <sup>4</sup>	A	Ln
022 1 2	024 1 2	026 1 2	028 1 2	030 1 2	032 1 2	034 1 2	036 1 2	038 1 2	040 1 2
					3	2	2	1	2
					3	4	3	4	3

1 Treatment Crops 2 BARLEY (sown 15 Mar) after Wheat 3 Treatment Crops 4 BARLEY after Wheat 5 WHEAT 6th Cereal

3 Treatment Crops 4 BARLEY after Wheat 5 WHEAT 6th Cereal

Note: Barley seed dressed with 'Milstem'

1973

FOSTERS

73/R/RN/2

25th year

LEY-ARABLE

Rothamsted

Sponsors: Blocks 1-4, A.E. Johnston. Blocks 5-12, D.B. Slope

111 112	113 112	115 112	117 112	119 112
41 12	12 12	14 12	13 12	13 12
LC	Lu	R3	A	Lπ
112 112	114 112	116 112	118 112	120 112
23 12	43 12	23 12	24 12	24 12

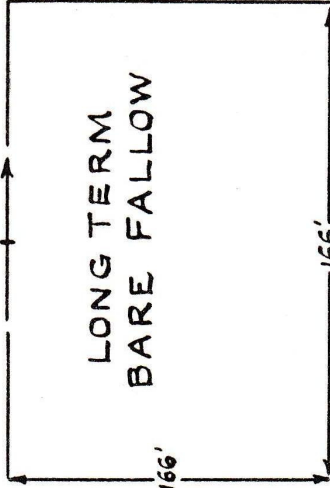

091 112	093 112	095 112	097 112	099 112	101 112	103 112	105 112	107 112	109 112
43 12	42 12	14 12	32 12	24 12	21 12	34 12	41 12	41 12	43 12
Lπ	Lu	LC	A	R3	LC	A	Lπ	Lu	R9
092 112	094 112	096 112	098 112	100 112	102 112	104 112	106 112	108 112	110 112
21 12	31 12	32 12	41 12	31 12	34 12	12 12	43 12	32 12	21 12

10 Wheat 4th Cereal

12 Wheat 4th Cereal

051 112	053 112	055 112	057 112	059 112
24 12	23 12	43 12	34 12	31 12
Lu	R9	LC	Lπ	A
052 112	054 112	056 112	058 112	060 112
13 12	41 12	21 12	12 12	24 12

6 Wheat 6th Cereal

061 112	063 112	065 112	067 112	069 112	071 112	073 112	075 112	077 112	079 112
32 12	42 12	12 12	13 12	13 12	43 12	41 12	13 12	21 12	12 12
LC	Lπ	Lu	R5	A	Lπ	LC	A	R8	Lu
062 112	064 112	066 112	068 112	070 112	072 112	074 112	076 112	078 112	080 112
41 12	13 12	34 12	42 12	42 12	21 12	32 12	42 12	43 12	34 12

7 Wheat 7th Cereal

001 112	003 112	005 112	007 112	009 112	011 112	013 112	015 112	017 112	019 112
34 12	30 12	31 12	RD 12	00 12	00 12	R 12	015 12	017 12	019 12
LC	A	Lu	Lπ	Lπ	Lπ	H	LC	Lu	Lu
002 112	004 112	006 112	008 112	010 112	012 112	014 112	016 112	018 112	020 112
00 12	02 12	10 12	10 12	12 12	12 12	12 12	12 12	12 12	12 12

1 POTATOES

021 112	023 112	025 112	027 112	029 112	031 112	033 112	035 112	037 112	039 112
23 12	30 12	11 12	31 12	R 12	031 12	033 12	035 12	R 12	039 12
Lu	Lπ	A	LC	Lπ	Lπ	Lu	LC	H	H
022 112	024 112	026 112	028 112	030 112	032 112	034 112	036 112	038 112	040 112
10 12	02 12	23 12	02 12	030 12	032 12	034 12	036 12	038 12	040 12

2 Treatment Crops

081 112	083 112	085 112	087 112	089 112
34 12	14 12	23 12	34 12	12 12
R9	Lπ	LC	A	Lu
082 112	084 112	086 112	088 112	090 112
12 12	23 12	41 12	12 12	34 12

9 Wheat 5th Cereal

041 112	043 112	045 112	047 112	049 112
24 12	23 12	24 12	24 12	32 12
Lu	LC	Lπ	R5	A
042 112	044 112	046 112	048 112	050 112
31 12	41 12	13 12	31 12	41 12

5 Wheat 7th Cereal

3 POTATOES

+ Treatment Crops 1st Year  
D FYM last applied in 1968

1st Test Crop

1962 1963 etc Year 'R' under 1st arable crop.

1962 1963 etc Year 'R' under 1st arable crop.

1st Test Crop

**ROTHAMSTED LEY - ARABLE** 26<sup>th</sup> year **74/R/RN/2** **FOSTERS 1974**

Sponsors: Blocks 1-4, A E Johnston Blocks 5-12, D B Slope

Rates of Nitrogen per acre  
Test crop Wheat BIKs 1-3

- 0 None
- 1 0.4 cwt N 50 Kg/ha
- 2 0.8 cwt N 100 Kg/ha
- 3 1.2 cwt N 150 Kg/ha

- To W. Wheat Blocks 5-12
- 1 0.6 cwt N 75 Kg/ha
  - 2 1.0 cwt N 126 Kg/ha
  - 3 1.4 cwt N 176 Kg/ha
  - 4 1.8 cwt N 226 Kg/ha

Nitrogen as 'Nitro-Chalk' 25 applied in spring

W. Variety: Cappelle

Dieldrin seed dressed

Sown at 180lb/a or

24 Oct 1973

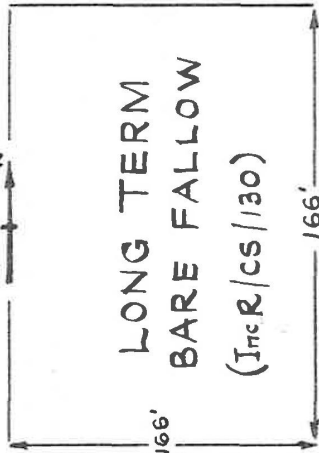

091 1.2	093 4.3	095 1.4	097 3.2	099 2.1	101 2.1	103 3.4	105 1.2	107 1.2	109 1.2
Ln	Lw	Lc	A	R <sup>3</sup>	Lc	A	Ln	Lw	R <sup>9</sup>
092 1.2	094 1.2	096 1.2	098 1.2	100 1.2	102 1.2	104 1.2	106 1.2	108 1.2	110 1.2
2.1	3.1	3.2	4.1	3.1	3.4	1.2	4.3	3.2	2.1

10 Wheat 5th cereal 11 Wheat 7th cereal

051 1.2	053 2.4	055 1.2	057 1.2	059 1.2
Lw	R <sup>9</sup>	Lc	Ln	A
052 1.2	054 1.2	056 1.2	058 1.2	060 1.2
1.3	4.1	2.1	1.2	2.4

6 Wheat 7th cereal

001 1.2	003 1.2	005 1.2	007 1.2	009 1.2	011 1.2	013 1.2	015 1.2	017 1.2	019 1.2
Lc	A	Lw	Lc	Ln	Ln	SB	Lc	Lw	Lw
002 1.2	004 1.2	006 1.2	008 1.2	010 1.2	012 1.2	014 1.2	016 1.2	018 1.2	020 1.2
2.0	1.1	3.0	3.4	3.3	3.4	3.4	3.4	3.4	1.1

1 WHEAT 2<sup>nd</sup> Test crop 2 Treatment crops 2<sup>nd</sup> year

R 3.4.5.8.9 = 1962, 1964, 1965 etc., the year 'R' under 1<sup>st</sup> arable crop.

111 1.2	113 1.2	115 1.2	117 1.2	119 1.2
Lc	Lw	R <sup>3</sup>	A	Ln
112 1.2	114 1.2	116 1.2	118 1.2	120 1.2
2.3	4.3	2.3	2.4	2.4

12 Wheat 5th cereal

061 1.2	063 3.2	065 4.2	067 1.3	069 1.2	071 1.2	073 1.2	075 1.2	077 1.2	079 1.2
Lc	Ln	Lw	R <sup>5</sup>	A	Ln	Lc	A	R <sup>8</sup>	Lw
062 1.2	064 1.2	066 1.2	068 1.2	070 1.2	072 1.2	074 1.2	076 1.2	078 1.2	080 1.2
4.1	1.3	3.4	4.2	4.2	2.1	3.2	4.2	4.3	3.4

7 Wheat 8th cereal 8 Wheat 6th cereal 9 Wheat 6th cereal

021 1.2	023 1.2	025 1.2	027 1.2	029 1.2	031 1.2	033 1.2	035 1.2	037 1.2	039 1.2
Lw	Ln	A	Lc	Lc	Ln	Lw	Lc	SB	SB
022 1.2	024 1.2	026 1.2	028 1.2	030 1.2	032 1.2	034 1.2	036 1.2	038 1.2	040 1.2
3.4	3.4	3.4	3.4	3.4	3.4	3.4	3.4	3.4	3.4

3 WHEAT 4 Treatment crops 2<sup>nd</sup> year 5 Wheat 8th cereal

R 3.4.5.8.9 = 1962, 1964, 1965 etc., the year 'R' under 1<sup>st</sup> arable crop.

FOSTERS 1975

75/R/RN/2  
Blocks 5-12 D.B. Slope

LEY-ARABLE 27th year  
Spensors: Blocks 1-4 AE Johnston, Blocks 5-12 D.B. Slope

Rothamsted

111	110	110	117	119
1 2				
4 1	1 2	1 4	1 3	1 3
LC	LU	R9	A	LN
112	111	110	110	110
1 2				
2 3	4 3	2 3	2 4	2 4

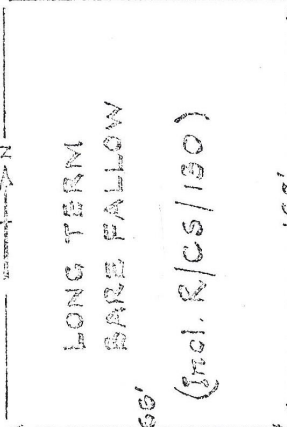

101	103	105	107	109
1 2				
2 1	3 4	1 2	4 1	4 3
LC	A	LN	LU	R9
102	104	106	108	110
1 2				
3 4	1 2	4 3	3 2	2 1

12 WHEAT 6th cereal

10 WHEAT 6th cereal 11 WHEAT 8th cereal

071	073	075	077	079
1 2				
4 3	4 1	1 3	2 1	1 2
LN	LC	A	RS	LU
072	074	076	078	080
1 2				
2 1	3 2	4 2	4 3	3 4

051	053	055	057	059
1 2				
1 4	2 3	4 3	3 4	3 1
LU	R9	LC	LN	A
052	054	056	058	060
1 2				
2 3	4 1	2 1	1 2	2 4

7 WHEAT 9th cereal 8 WHEAT 7th cereal 9 WHEAT 7th cereal

6 WHEAT 8th cereal

021	023	025	027	029
1 2	1 2	1 2	1 2	1 2
3 3	0 2	2 1	0 1	R*
3 4	3 4	3 4	3 4	C/N
0 2	2 3	0 2	2 2	
LU	LN	A	LC	///
022	024	026	028	030
1 2	1 2	1 2	1 2	1 2
1 1	1 0	3 3	1 0	
3 4	3 4	3 4	3 4	
0 2	2 3	1 0	3 3	

011	013	015	017	019
1 2	1 2			
	R*			
	C/N			
LN	///	O	LC	LU
012	014	016	018	020
1 2	1 2			
1 1	1 1			
3 4	3 4			
1 1	1 1			

3 WHEAT 4 Treatment crops 5 WHEAT 9th cereal

2 Treatment crops 3rd Test crop

Note: R\*, R# etc refers to year R (Reseeded grass) under 1st arable crop, ie 1963, 1964

Selected Plan  
sub-plots 0511\*  
incl 0521  
cultivants transposed  
field.

WW - Cappelle  
sown at 180 lb/acre  
with 336 lb/ha (376 kg/ha)  
of (0:20:20) ca.

Blks 5-12 sown 15 Oct 1974  
Blks 1-3 sown 31 Oct 1974  
id in error order of N's  
reversed.

Rothamsted LEY-ARABLE 28th Year 76/R/RN/2 FOSTERS 1976

Sponsors: Blocks 1-4 A.E. Johnston, Blocks 5-12 D.B. Slope

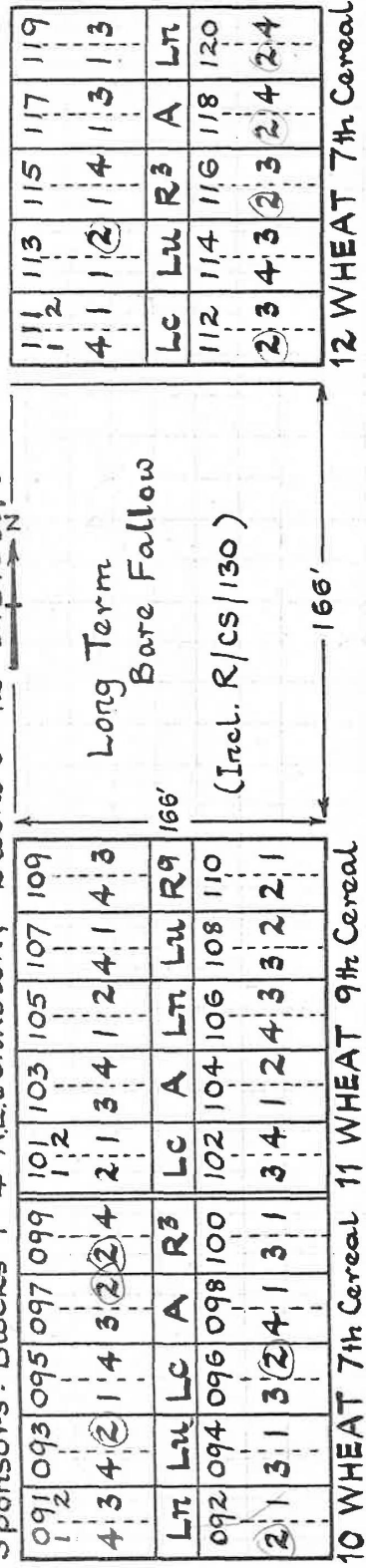

Varieties:

WW Cappelle  
Sown: 22 Oct 75  
P Pentland  
Crown

Rotation  
symbols

12 WHEAT 7th Cereal

081	082	083	084	085	086	087	088	089
1 2	3 4	1 4	2 3	3 4	1 2	3 4	1 2	3 4
LC	Lu	R <sup>3</sup>	A	Ln	Lu	A	Ln	Lu
111	112	113	114	115	116	117	118	119
1 2	3 4	1 2	3 4	1 4	2 3	1 3	1 3	1 3
LC	Lu	Lu	R <sup>3</sup>	R <sup>3</sup>	A	A	Ln	Ln
2 3	4 3	2 3	2 3	2 3	2 4	2 4	2 4	2 4

10 WHEAT 9th Cereal

061	062	063	064	065	066	067	068	069
1 2	3 4	1 2	3 4	1 2	3 4	1 2	3 4	1 2
Ln	LC	Ln	LC	Ln	LC	Ln	LC	Ln
071	072	073	074	075	076	077	078	079
1 2	3 4	1 2	3 4	1 3	2 1	1 2	3 4	1 2
Ln	LC	Ln	LC	A	R <sup>8</sup>	Lu	Lu	Lu
081	082	083	084	085	086	087	088	089
1 2	3 4	1 2	3 4	1 3	2 1	1 2	3 4	1 2
R <sup>8</sup>	R <sup>8</sup>	Ln	Ln	Ln	Lu	Lu	A	Lu

11 WHEAT 9th Cereal

051	052	053	054	055	056	057	058	059
1 2	3 4	2 3	4 3	4 3	4 3	4 3	1 2	3 1
Lu	R <sup>9</sup>	LC	Ln	A	Ln	A	Ln	A
091	092	093	094	095	096	097	098	099
1 2	3 4	1 4	3 2	4 2	4 3	2 4	1 3	1 3
LC	Ln	LC	A	R <sup>3</sup>	A	R <sup>3</sup>	Lu	R <sup>9</sup>
2 1	3 1	3 2	4 1	3 1	3 4	1 2	3 2	2 1

6 WHEAT 9th Cereal

001	002	003	004	005	006	007	008	009
1 2	3 4	1 2	3 4	1 2	3 4	1 2	3 4	1 2
Ln	LC	Ln	LC	Ln	LC	Ln	LC	Ln
011	012	013	014	015	016	017	018	019
1 3	2 1	3 2	4 1	3 2	4 1	3 2	4 1	2 1
R*	R*	R*	R*	R*	R*	R*	R*	R*
n.c	n.c	n.c	n.c	n.c	n.c	n.c	n.c	n.c
LC	Lu	Lu	Lu	Lu	Lu	Lu	Lu	Lu
021	022	023	024	025	026	027	028	029
1 2	3 4	1 2	3 4	1 2	3 4	1 2	3 4	1 2
Lu	Ln	Ln	Ln	Ln	Ln	Ln	Ln	Ln
031	032	033	034	035	036	037	038	039
2 1	3 2	4 1	3 2	4 1	3 2	4 1	3 2	4 1
R*	R*	R*	R*	R*	R*	R*	R*	R*
n.c	n.c	n.c	n.c	n.c	n.c	n.c	n.c	n.c
Lu	Lu	Lu	Lu	Lu	Lu	Lu	Lu	Lu

1 Treatment Crops 2 POTATOES (P.W.)

1st Year

Note: R<sup>3</sup>, R<sup>4</sup> etc, refers to year (Reseeded grass)

8 WHEAT 8th Cereal

021	022	023	024	025	026	027	028	029
1 2	3 4	1 2	3 4	1 2	3 4	1 2	3 4	1 2
Ln	LC	Ln	LC	Ln	LC	Ln	LC	Ln
031	032	033	034	035	036	037	038	039
2 1	3 2	4 1	3 2	4 1	3 2	4 1	3 2	4 1
R*	R*	R*	R*	R*	R*	R*	R*	R*
n.c	n.c	n.c	n.c	n.c	n.c	n.c	n.c	n.c
Lu	Lu	Lu	Lu	Lu	Lu	Lu	Lu	Lu
041	042	043	044	045	046	047	048	049
1 2	3 4	1 2	3 4	1 2	3 4	1 2	3 4	1 2
Lu	Ln	Ln	Ln	Ln	Ln	Ln	Ln	Ln
051	052	053	054	055	056	057	058	059
1 2	3 4	1 2	3 4	1 2	3 4	1 2	3 4	1 2
LC	Lu	Lu	Lu	Lu	Lu	Lu	Lu	Lu
061	062	063	064	065	066	067	068	069
1 2	3 4	1 2	3 4	1 2	3 4	1 2	3 4	1 2
LC	Ln	Ln	Ln	Ln	Ln	Ln	Ln	Ln
071	072	073	074	075	076	077	078	079
1 2	3 4	1 2	3 4	1 3	2 1	1 2	3 4	1 2
Ln	LC	Ln	LC	A	R <sup>8</sup>	Lu	Lu	Lu
081	082	083	084	085	086	087	088	089
1 2	3 4	1 2	3 4	1 3	2 1	1 2	3 4	1 2
R <sup>8</sup>	R <sup>8</sup>	Ln	Ln	Ln	Lu	Lu	A	Lu

3 Treatment Crops 4 POTATOES (P.W.)

1st Year

Note: R<sup>3</sup>, R<sup>4</sup> etc, refers to year (Reseeded grass)



Rollamsted LEY-MARBLE 29<sup>th</sup> Year 77/R/RN/2 FOSTERS 1977  
 Sponsors: Blochs 1-4 A.E. Johnston. Blochs 5-12 D.B. Slope

111	113	115	117	119
Lc	Lc	R3	A	Lm
112	114	116	118	120
12 WHEAT 8 <sup>th</sup> General				

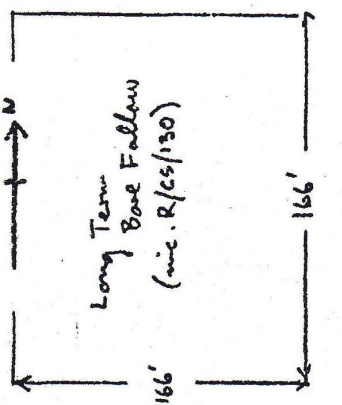

091	093	095	097	099	101	103	105	107	109
Lm	Lc	Lc	A	R3	FALLOW				
092	094	096	098	100	(Lc) (A) (Lm) (Lu) (R9) (R9)				
10 WHEAT 8 <sup>th</sup> General									

**NEW SEQUENCES (Block 507):**  
 LU Luscum or bitter, which resistant to Verticillium  
 LC Green/clover, dry, or blitters/spicy, or blitters/umbelliferous  
 RG Perennial ryegrass (3 years) - from choice of mix  
 B Barley, Tullin  
 O Oats, Mamod

ALL SPRING (1977) SOWN

**WHEAT (Blochs 8, 9, 10, 12):**  
 Caffelle, base N (125kg/ha) - no yields  
 Sown 25/11/77  
**WHEAT (Blochs 2, 4):**  
 Caffelle, base N - 1, 2, 3:  
 0, 50, 100, 150 kg N/ha.  
 Yields required  
 Sown 24/11/77

081	083	085	087	089
R6	Lm	Lc	A	Lc
082	084	086	088	090
9 WHEAT 9 <sup>th</sup> General				

071	073	075	077	079
Lm	Lc	A	R6	Lc
072	074	076	078	080
8 WHEAT 9 <sup>th</sup> General				

061	063	065	067	069
Lc	RG	Lc	B	O
062	064	066	068	070
7 NEW SEQUENCES				

051	053	055	057	059
FALLOW				
(Lm) (R9) (Lc) (Lm) (A)				
6				

041	043	045	047	049
Lc	Lc	RG	B	O
042	044	046	048	050
5 NEW SEQUENCES 23'				

031	033	035	037	039
2 1	- 2	2 1	R	- 2
D F	F F	F D	c n	D D
Lm	Lc	Lc	///	A
032	034	036	038	040
- 13	3 1	3	1	1 3
D F	D D	D F	F F	F F
4 WHEAT 2 <sup>nd</sup> Test Crop (P.W.M.)				

021	023	025	027	029
Lc	Lm	Sb	Lc	///
022	024	026	028	030
3 Treatment Crops 2 <sup>nd</sup> Year				

011	013	015	017	019
1 3	R	- 13	3 2	2 1
D D	c n	F D	F D	D F
Lm	///	A	Lc	Lc
012	014	016	018	020
- 2	1 2	1 1	- 1	- 3
F F	D F	D F	D F	D F
2 WHEAT 2 <sup>nd</sup> Test Crop (P.W.M.)				

001	003	005	007	009
1 2			R	
Lc	Sb	Lc	///	Lm
002	004	006	008	010
1 Treatment Crops 2 <sup>nd</sup> Year				

# revised March 1977 incorporating N test to blocks 2 & 4

NOTE: R3, R5 etc refer to year that received grass first molar number crop (1963, 1965 etc.)  
 Residues: F. D None. Dury

1978

TOCTLES

78 R/RN/2

FOR YEAR

KEY - ARABIC

FOLLOWING

Sponsors: Blocks 1-4 A.F. Johnston, Blocks 5-12 D.B. Slope

WHEAT SEEDS 10,12  
Cappelle, basal N @ 125 kg/ha, no yields.

NEW SEQUENCES (Blocks 5, 6, 7, 8)  
Lu Lucerne, Vertus  
Lc Grass/clover as 1977  
Rq Perennial ryegrass (3 yrs as 1977)

B Barley, Julia  
O Oats, Manod  
P Potatoes, Pentland Crown  
WHEAT (Blocks 2 & 4)  
Cappelle, Test N, Yields required  
-1, 2, 3 : 0, 50, 100, 150 Kg N/ha  
TREATMENT CROPS (Blocks 1 & 3)  
Lu Lucerne  
Lc Grass ley  
Lc Grass/clover ley  
O Oats, Manod  
R Reseeded grass

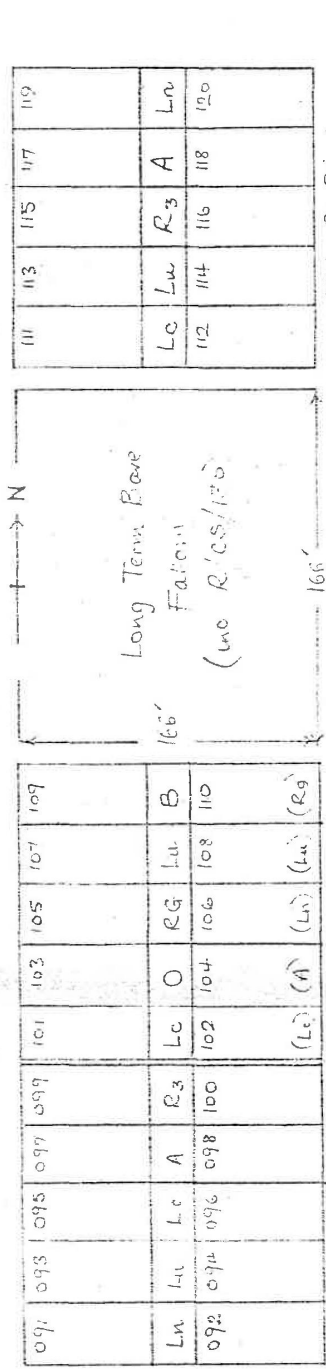

Block	091	093	095	097	099	101	103	105	107	109
	Lu	Lu	Lc	A	R3	Lc	O	Rq	Lu	B
	092	094	096	098	100	102	104	106	108	110
	(Lc)	(Lc)	(A)	(Lu)	(Lu)	(Lc)	(A)	(Lu)	(Lu)	(Rq)

Block	051	053	055	057	059
	Lu	B	Lc	R1	O
	052	054	056	058	060
	(Lu)	(Rq)	(Lc)	(Lu)	(A)

Block	061	063	065	067	069
	Lc	Rq	Lu	B	P
	062	064	066	068	070
	(Lc)	(Lu)	(Lu)	(R5)	(A)

Block	071	073	075	077	079
	FALLOW	FALLOW	FALLOW	FALLOW	FALLOW
	072	074	076	078	080
	(Lu)	(Lc)	(A)	(R8)	(Lu)

Block	081	083	085	087	089
	(R5)	(Lu)	(Lc)	(A)	(Lu)
	082	084	086	088	090
	(Lu)	(Lc)	(Lu)	(R5)	(A)

Block	021	023	025	027	029
	Lu	Lw	O	Lc	R
	022	024	026	028	030
	(Lu)	(Lw)	(O)	(Lc)	(R)

Block	031	033	035	037	039
	Lu	Lu	Lc	A	(P)(F)
	032	034	036	038	040
	(Lu)	(Lu)	(Lc)	(A)	(P)(F)

Block	041	043	045	047	049
	Lu	Lc	Rq	B	P
	042	044	046	048	050
	(Lu)	(Lc)	(Lu)	(R5)	(A)

NOTE: R3, Rq etc. refers to year that reseeded (R) grass first under arable crop (1963, 1969 etc)  
(F)(P): None, being (residual treatments) C, R : None, N & K top dressed in spring & after each cut except the last

POTHAMSTED KEY-FARABLE 31st year 1979 FOSTERS  
 Sponsors: Blocks 1-4 AE Johnson, Blocks 5-12 D.B. Slope

CROPPING

NEW SEQUENCES (Blocks 5, 6, 7, 8, 9, 11)

- L4 Lucerne vetch
- Lc Grass/Clver
- Rg Perennial ryegrass
- W W. Wheat, Flanders
- BE Beans, Marston
- B Barley, Potlton
- O Oats, Monod
- P Potatoes, Pentland Crown (FS)

POTATOES (Blocks 1 + 3)

Pentland Crown Test N Yields required  
 - 1, 2, 3: 0, 80, 160, 240 RgN/ha

TREATMENT CROPS (Blocks 2 + 4)

- L4 Lucerne
- Ln Grass ley
- Lc Grass/Clver ley
- R Reseeded grass
- H 1st year hay

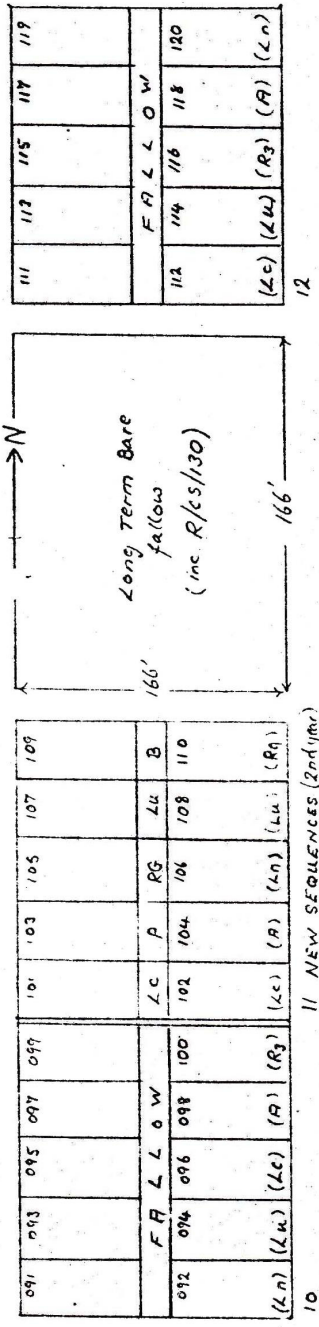

10 NEW SEQUENCES (2nd year)

091	093	095	097	099	101	103	105	107	109
					Lc	P	Rg	L4	B
092	094	096	098	100	102	104	106	108	110
(Ln)	(L4)	(Lc)	(A)	(Rg)	(Lc)	(A)	(Ln)	(L4)	(Rg)

061	063	065	067	069	071	073	075	077	079	081	083	085	087	089
					Rg	Lc	O	B	L4					
062	064	066	068	070	072	074	076	078	080	082	084	086	088	090
(Lc)	(Ln)	(L4)	(Rg)	(A)	(Ln)	(Lc)	(A)	(Rg)	(L4)	(Rg)	(Ln)	(Lc)	(A)	(L4)

6 NEW SEQUENCES (2nd year)

051	053	055	057	059
052	054	056	058	060
(L4)	(Rg)	(Lc)	(Ln)	(A)

7 NEW SEQUENCES (3rd year)

021	023	025	027	029	031	033	035	037	039	041	043	045	047	049
022	024	026	028	030	032	034	036	038	040	042	044	046	048	050
(Ln)	(F)	(D)	(F)	(D)	(F)	(D)	(F)	(D)	(F)	(D)	(F)	(D)	(F)	(D)

8 NEW SEQUENCES (1st year)

021	023	025	027	029	031	033	035	037	039	041	043	045	047	049
022	024	026	028	030	032	034	036	038	040	042	044	046	048	050
(Ln)	(F)	(D)	(F)	(D)	(F)	(D)	(F)	(D)	(F)	(D)	(F)	(D)	(F)	(D)

9 NEW SEQUENCES (1st year)

021	023	025	027	029	031	033	035	037	039	041	043	045	047	049
022	024	026	028	030	032	034	036	038	040	042	044	046	048	050
(Ln)	(F)	(D)	(F)	(D)	(F)	(D)	(F)	(D)	(F)	(D)	(F)	(D)	(F)	(D)

5 NEW SEQUENCES (2nd year)

021	023	025	027	029	031	033	035	037	039	041	043	045	047	049
022	024	026	028	030	032	034	036	038	040	042	044	046	048	050
(Ln)	(F)	(D)	(F)	(D)	(F)	(D)	(F)	(D)	(F)	(D)	(F)	(D)	(F)	(D)

4 TREATMENT CROPS (1st year)

021	023	025	027	029	031	033	035	037	039	041	043	045	047	049
022	024	026	028	030	032	034	036	038	040	042	044	046	048	050
(Ln)	(F)	(D)	(F)	(D)	(F)	(D)	(F)	(D)	(F)	(D)	(F)	(D)	(F)	(D)

3 POTATOES (1st year)

021	023	025	027	029	031	033	035	037	039	041	043	045	047	049
022	024	026	028	030	032	034	036	038	040	042	044	046	048	050
(Ln)	(F)	(D)	(F)	(D)	(F)	(D)	(F)	(D)	(F)	(D)	(F)	(D)	(F)	(D)

2 TREATMENT CROPS (1st year)

001	003	005	007	009	011	013	015	017	019
002	004	006	008	010	012	014	016	018	020
(Ln)	(F)	(D)	(F)	(D)	(Ln)	(F)	(D)	(Ln)	(F)

NOTE: R, Rg etc. refers to year that reseeded (R) grass first under arable crop (1963, 1969 etc)  
 (F), (D): None, Dung (residual treatments); c, n: None, N + K top dressed in Spring and after each year except the last.