

Thank you for using eradoc, a platform to publish electronic copies of the Rothamsted Documents. Your requested document has been scanned from original documents. If you find this document is not readable, or you suspect there are some problems, please let us know and we will correct that.



ROTHAMSTED  
RESEARCH

# Collection of Plans for the Fosters Ley-arable Experiment



[Full Table of Content](#)

## Fosters Ley-arable 1960-69

### Rothamsted Research

Rothamsted Research (1949-1990) *Fosters Ley-arable 1960-69* ; Collection Of Plans For The Fosters Ley-Arable Experiment, pp 12 - 21

**FOSTERS  
3-YEAR ARABLE  
ROTATIONS  
code Letter M  
WELFTH YEAR**

**1960**

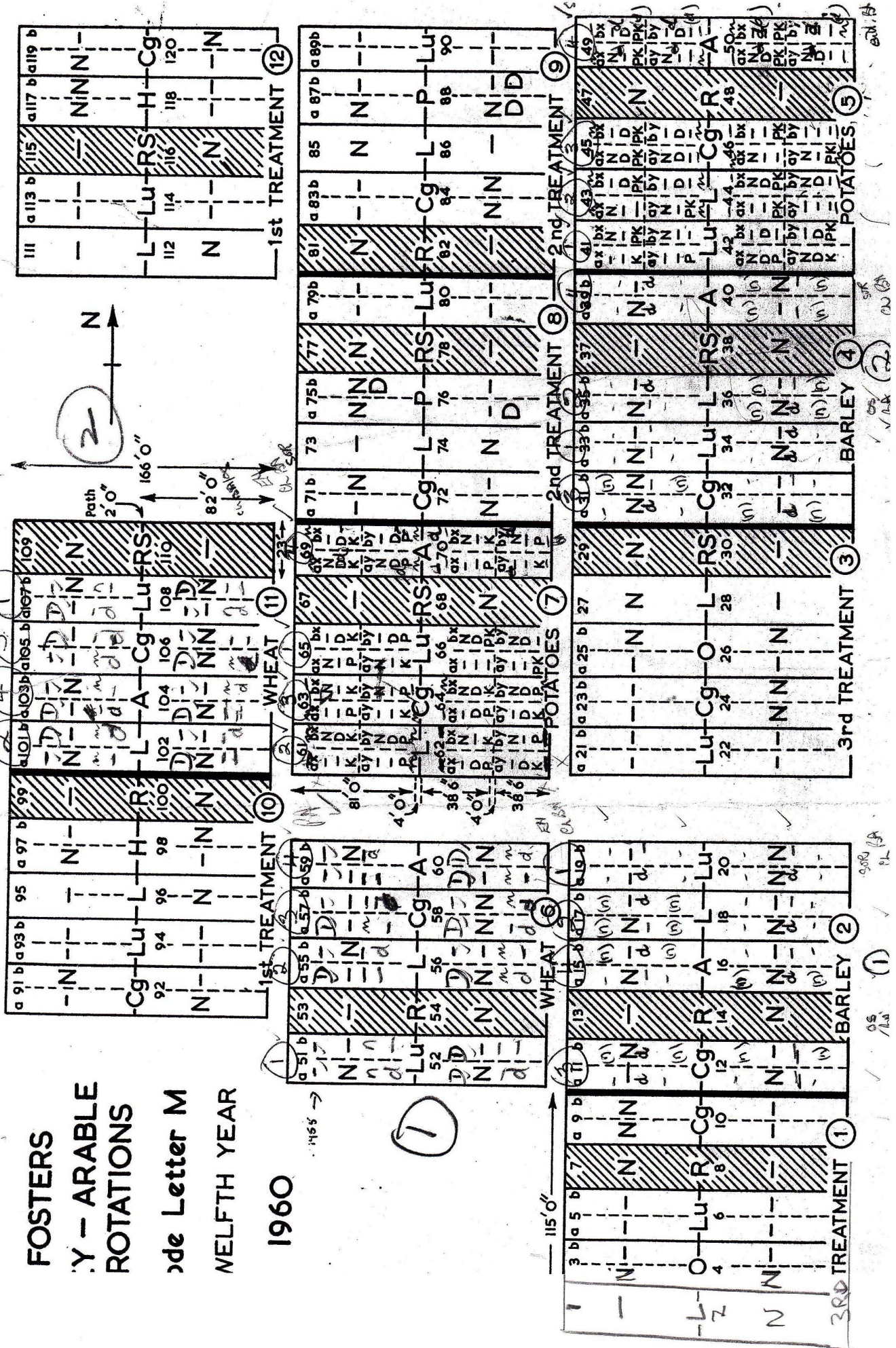



Site of Permanent Bore follow

111	113	115	117	119
a b	a b	a b	a b	a b
L	LU	R	S	Cg
112	114	116	118	120
a b	a b	a b	a b	a b
2nd Treatment				

12

F = PK in place of dung (D) to potatoes.

L	A	Cg	LU
101 b	103 b	105 b	107 b
a b	a b	a b	a b
PK	PK	PK	PK
DN	DN	DN	DN
FN	FN	FN	FN
102 b	104 b	106 b	108 b
a b	a b	a b	a b
PK	PK	PK	PK
DN	DN	DN	DN
FN	FN	FN	FN
109	110		
a b	a b		
R			

POTATOES

99	97	RS
a b	a b	
95	96	S
a b	a b	
Cg	LU	L
92	94	98
a b	a b	a b
2nd Treatment		

10

FOSTERS  
LEY - ARABLE  
ROTATIONS  
Code letter M  
13th Year  
1961

LU	L	A
51 a,b	53	59 b
a b	a b	a b
PK	PK	PK
DN	DN	DN
FN	FN	FN
52 a,b	54	60 b
a b	a b	a b
PK	PK	PK
DN	DN	DN
FN	FN	FN
RS		

POTATOES

L	Cg	LU
11	13	15
a b	a b	a b
17	19	
a b	a b	
L	L	LU
12	14	16
a b	a b	a b
1st Treatment		
L	LU	RS
7	9	11
a b	a b	a b
13	15	17
a b	a b	a b
L	LU	RS
5	7	9
a b	a b	a b
11	13	15
a b	a b	a b
L	LU	RS
3	5	7
a b	a b	a b
9	11	13
a b	a b	a b
L	LU	RS
1	3	5
a b	a b	a b
7	9	11
a b	a b	a b
L	LU	RS
1	3	5
a b	a b	a b
7	9	11
a b	a b	a b
L	LU	RS
1	3	5
a b	a b	a b
7	9	11
a b	a b	a b

WHEAT

81	83	85	87	89
a b	a b	a b	a b	a b
RS	Cg	L	O	LU
82	84	86	88	90
a b	a b	a b	a b	a b
3rd Treatment				

3rd Treatment

73	75	77	79
a b	a b	a b	a b
L	O	R	LU
74	76	78	80
a b	a b	a b	a b
3rd Treatment			

69	71	73	75	77	79
a b	a b	a b	a b	a b	a b
L	O	R	LU		
70	72	74	76	78	80
a b	a b	a b	a b	a b	a b
3rd Treatment					

61	63	65	67	69	71
a b	a b	a b	a b	a b	a b
LU	R	A	Cg	L	LU
62	64	66	68	70	72
a b	a b	a b	a b	a b	a b
3rd Treatment					

55	57	59
a b	a b	a b
L	Cg	A
56	58	60
a b	a b	a b
POTATOES		

11	13	15
a b	a b	a b
Cg	RS	H
12	14	16
a b	a b	a b
1st Treatment		

7	9
a b	a b
L	RS
8	10
a b	a b
WHEAT	

5	7
a b	a b
L	RS
6	8
a b	a b
WHEAT	

3	5
a b	a b
L	RS
4	6
a b	a b
WHEAT	

1	3
a b	a b
L	RS
2	4
a b	a b
WHEAT	

41	43	45	47	49
a b	a b	a b	a b	a b
L	L	Cg	RS	A
42	44	46	48	50
a b	a b	a b	a b	a b
2nd Treatment				

31	33	35	37	39
a b	a b	a b	a b	a b
L	L	R	H	
32	34	36	38	40
a b	a b	a b	a b	a b
1st Treatment				

21	23	25	27	29
a b	a b	a b	a b	a b
L	Cg	A	L	R
22	24	26	28	30
a b	a b	a b	a b	a b
1st Treatment				

1	3	5	7	9
a b	a b	a b	a b	a b
L	Cg	A	L	R
2	4	6	8	10
a b	a b	a b	a b	a b
WHEAT				

1	3	5	7	9
a b	a b	a b	a b	a b
L	Cg	A	L	R
2	4	6	8	10
a b	a b	a b	a b	a b
WHEAT				

1	3	5	7	9
a b	a b	a b	a b	a b
L	Cg	A	L	R
2	4	6	8	10
a b	a b	a b	a b	a b
WHEAT				

1	3	5	7	9
a b	a b	a b	a b	a b
L	Cg	A	L	R
2	4	6	8	10
a b	a b	a b	a b	a b
WHEAT				

1	3	5	7	9
a b	a b	a b	a b	a b
L	Cg	A	L	R
2	4	6	8	10
a b	a b	a b	a b	a b
WHEAT				

7 2 3 4 3

2 4 2

4 2

3 4 2 3

14th YEAR 1962

Code letter: FLA

LEY-ARABLE ROTATIONS

ROTHAMSTED

# FOSTERS

- SYMBOLS:**  
 LU1 LEYS  
 Ley Cg Cut grass } 2nd & 3rd year  
 Cg3 L Grazed }  
 Lc Clover grass without N } 1st year  
 Lh4 Straight grass with N }  
 Lu Lucerne for hay }  
 All Leys mown except L'  
 A ARABLE Rotation  
 H Hay, Sb. Sugarbeet, O Oats

- TEST CROPS**  
 W WHEAT P POTATOES B BARLEY  
 Reseeded Permanent Grass  
 R Grazed  
 S Silage cut in May

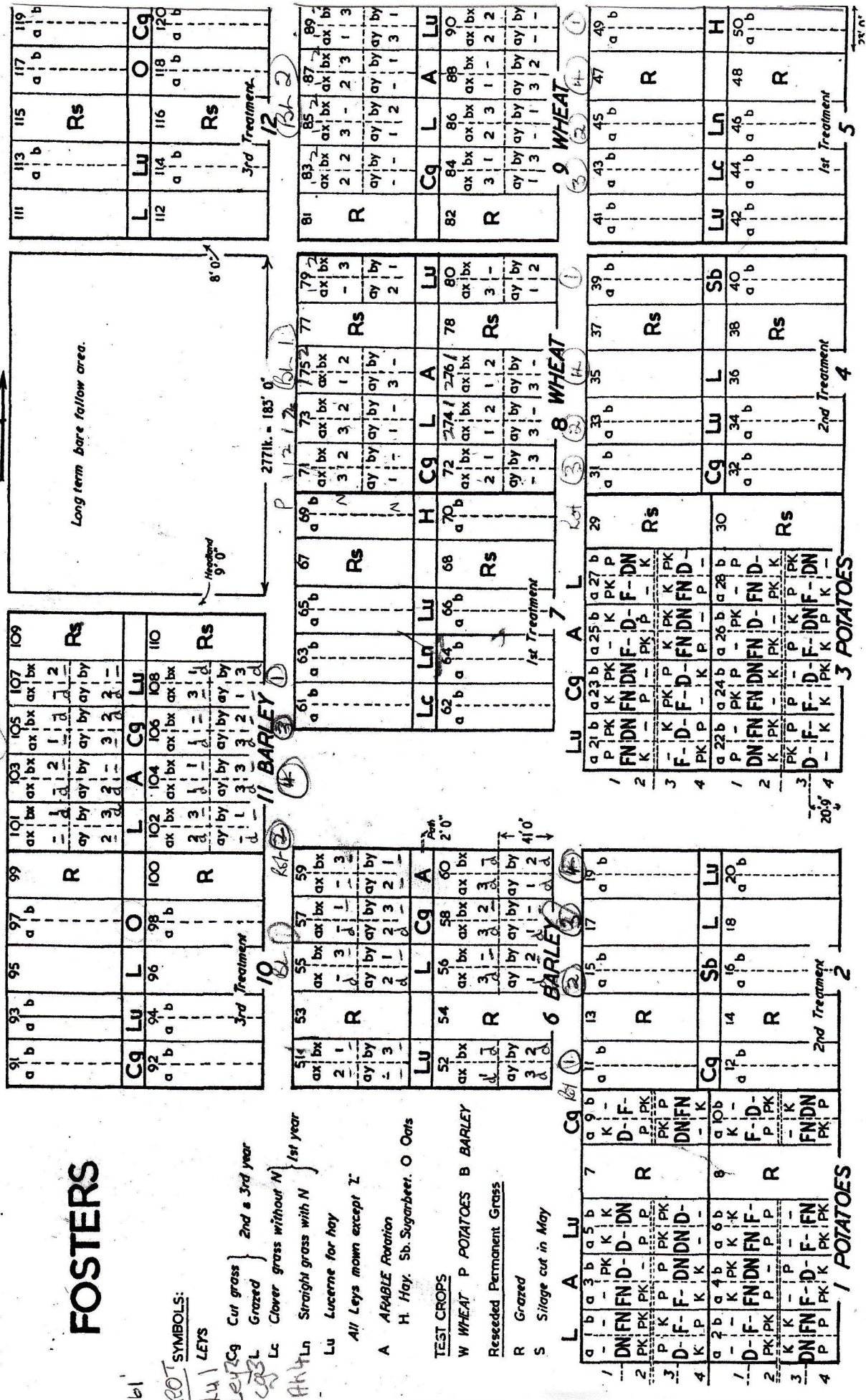

61 Rot Rep. N  
n = N 15 Wheat 1962

Rothamsted:

LEY ARABLE ROTATION

Code letter: FLA

15th Year: 1963

# FOSTERS

## Symbols:

- LEYS
- Cg Cut grass } 3rd year
- L Grazed
- L Clover grass without N
- Lc Straight grass with N
- Lucerne for hay

All Leys mown except 'L'

ARABLE Rotation  
H Hay Sb Sugar-beet  
O Oats

Reseeded grass ploughed up.

T. CROPS  
WHEAT P POTATOES  
BARLEY

seeded and Old Permanent Grass

& G Grazed

Silage cut in May

c & Gc No N } Mown

Ln & Gn With N }

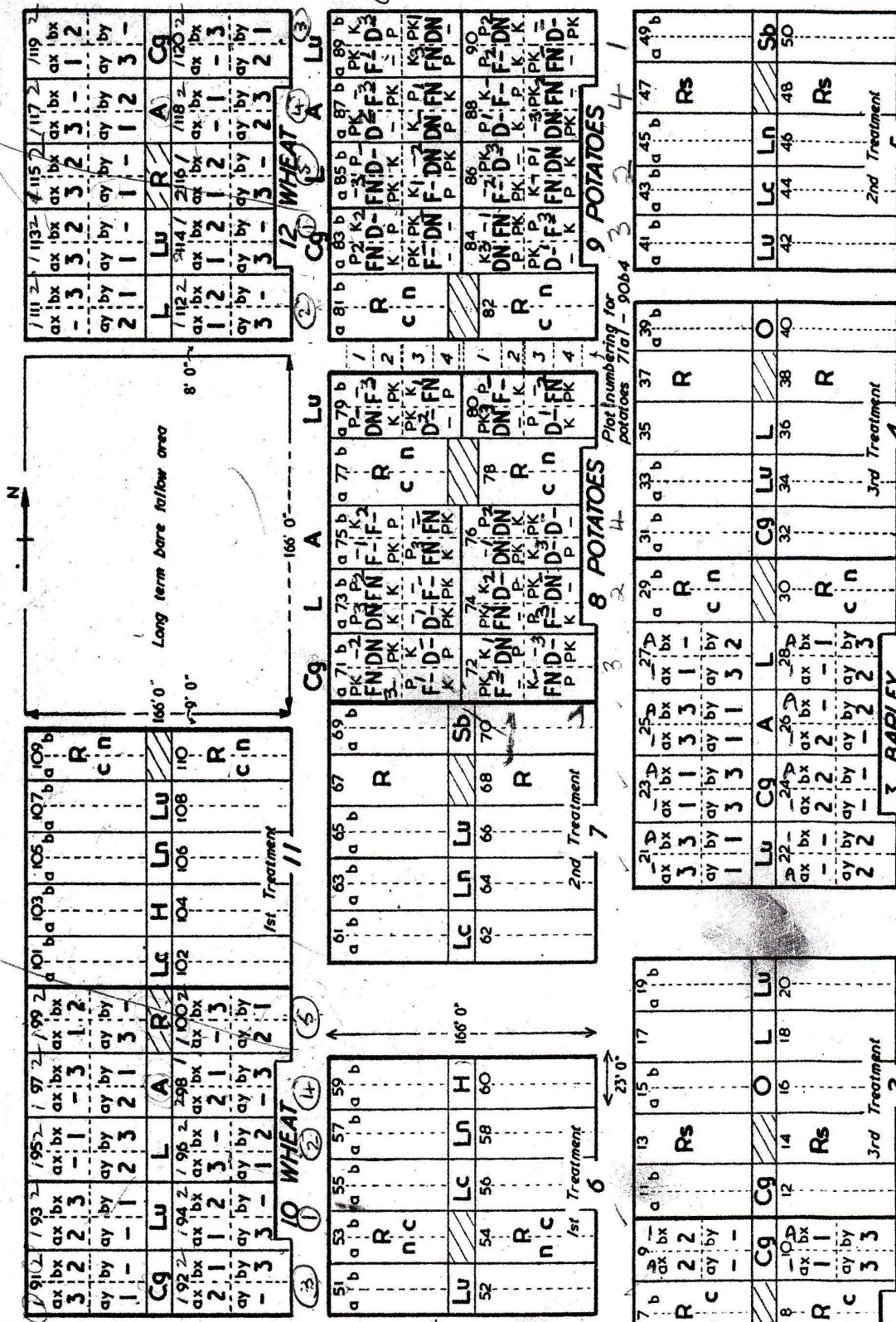

Handwritten notes and circled numbers: 1, 2, 3, 4, 5, 6, 7, 8, 9, 10, 11, 12, 13, 14, 15, 16, 17, 18, 19, 20, 21, 22, 23, 24, 25, 26, 27, 28, 29, 30, 31, 32, 33, 34, 35, 36, 37, 38, 39, 40, 41, 42, 43, 44, 45, 46, 47, 48, 49, 50. Includes 'Block 1', 'Block 2', '3 3/11 33/10', 'sc1', '2/18', and '3 3 BARLEY'.

Rothamsted

LEY - ARABLE ROTATION

Code letter FLA

16th. Year 1964.

# FOSTERS

## SYMBOLS

- Rotations. All 3yr. leys cut.
- Lc Grass/clover-NoN.(L) 4
- Ln Grass-with N. (Cg)
- Lu Lucerne.
- A Arable: H Hay.
- Sb Sugarbeet.
- O Oats.
- L Previously Grazed ley.
- Cg Previously Cut grass.

## TEST CROPS:

- P Potatoes.
- W W. Wheat.
- B Barley.

## Reseeded & Old Permanent Grass.

- R & G Grazed.
  - s Cut for silage in May.
  - Rc, Gc Without N } Cut
  - Rn, Gn With N }
- Note: From Autumn 1964 R is ploughed up as each block comes into Test Crop Wheat.

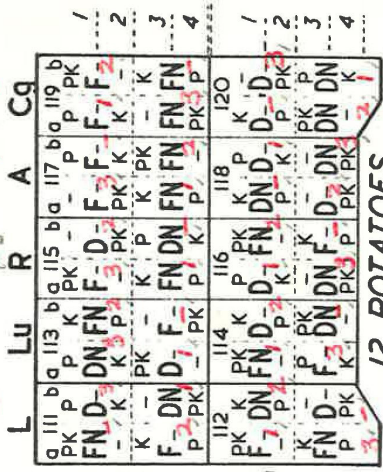

Plot numbering for potatoes IIIa1 - 120 b 4

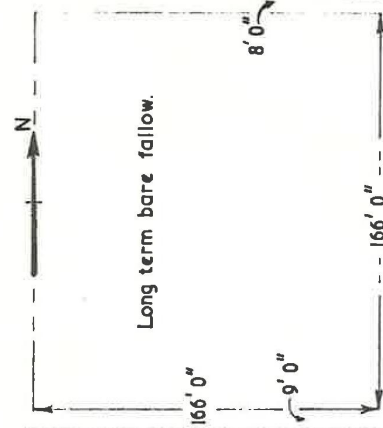

Plot numbering for potatoes IIIa1 - 120 b 4

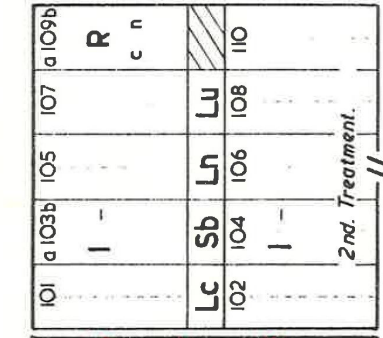

Plot numbering for potatoes IIIa1 - 120 b 4

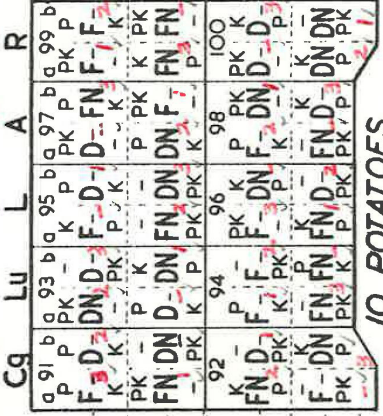

Plot numbering for potatoes IIIa1 - 120 b 4



Plot numbering for potatoes IIIa1 - 120 b 4

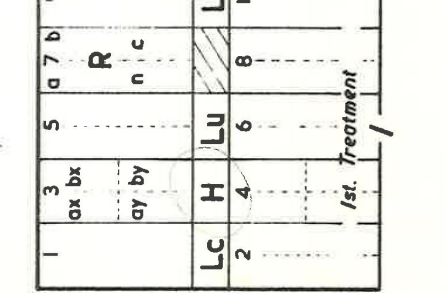
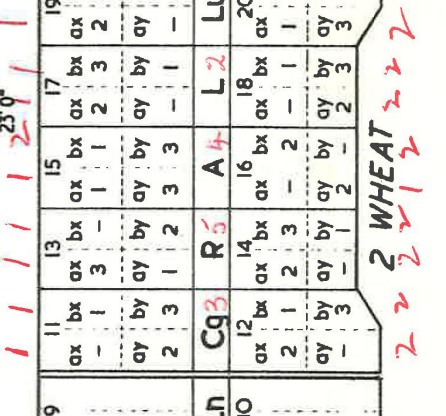
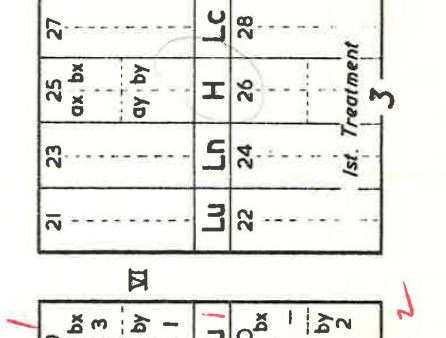
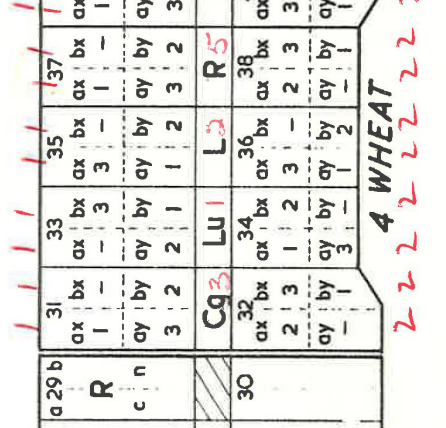
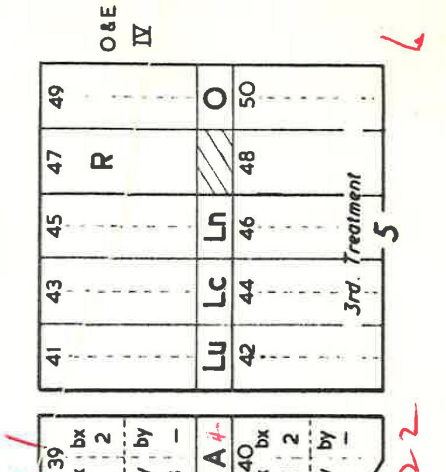
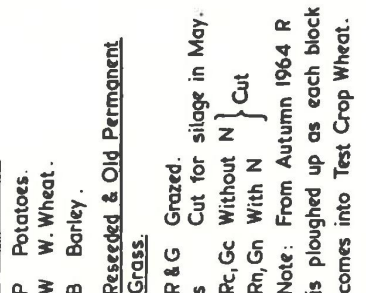
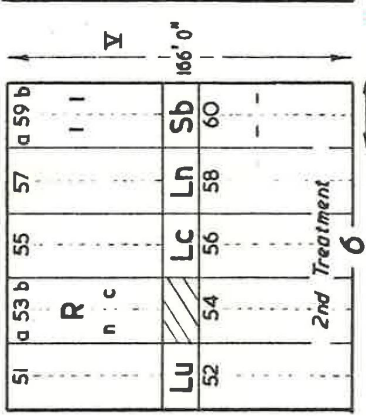
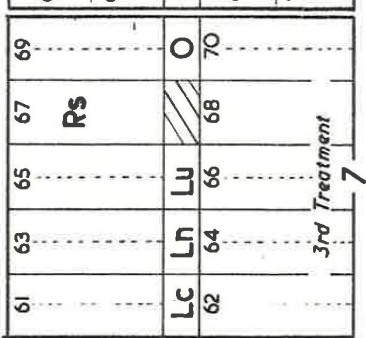
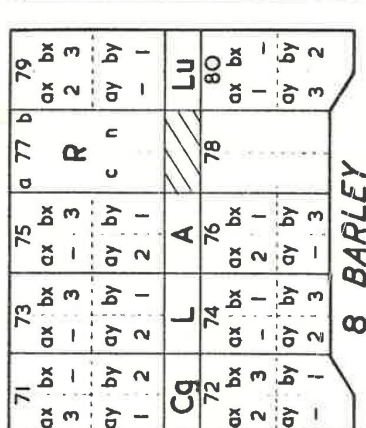
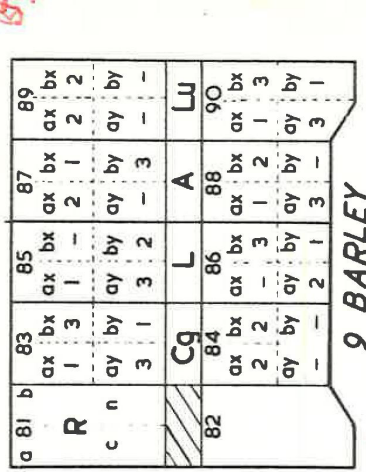

Rothamsted LEY - ARABLE 17th Year F.L.A FOSTERS 1965 10

SYMBOLS

TREATMENT CROPS

3 year Leys 1962 - Cut.

Lc Grass/clover - No N.

Lr Grass with N.

Lul Lucerne

3 year Leys 1949 - 64

L Grazed ley

Cg Cut grass

3 years Arable "A"

H Hay Sb Sugar beet

O Oats

R Long-term

Reseeded grass

TEST CROPS

W WHEAT

P POTATOES

B BARLEY

Old Permanent Grass

& Reseeded Grass

Gc, Rc Without N } cut

Gr, Rn With N }

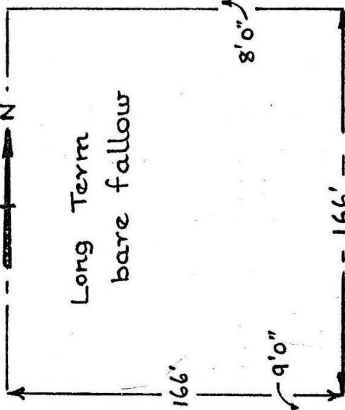

101	103	105	107	109
Lc	O	Lr	Lul	A
102	104	106	108	110
3rd Treatment				

91	93	95	97	99
Cg	Lul	L	A	R
92	94	96	98	100
3rd Treatment				

111	113	115	117	119
L	Lul	R	A	Cg
112	114	116	118	120
3rd Treatment				

51	53	55	57	59
Lul	Lc	Lr	O	
52	54	56	58	60
3rd Treatment				

61	63	65	67	69
Lc	Lr	Lul	R	A
62	64	66	68	70
3rd Treatment				

81	83	85	87	89
Lr	Lc	H	Lul	
82	84	86	88	90
1st Treatment				

71	73	75	77	79
Lr	Lc	H	Lul	
72	74	76	78	80
1st Treatment				

21	23	25	27	29
Lul	Lr	Sb	Lc	
22	24	26	28	30
2nd Treatment				

31	33	35	37	39
Cg	Lul	L	R	A
32	34	36	38	40
2nd Treatment				

41	43	45	47	49
Lul	Lc	Lr	R	A
42	44	46	48	50
2nd Treatment				

1	3	5	7	9
Lc	Sb	Lul	Lr	
2	4	6	8	10
2nd Treatment				

11	13	15	17	19
Cg	R	A	L	Lul
12	14	16	18	20
2nd Treatment				

21	23	25	27	29
Lul	Lr	Sb	Lc	
22	24	26	28	30
2nd Treatment				

31	33	35	37	39
Cg	Lul	L	R	A
32	34	36	38	40
2nd Treatment				

41	43	45	47	49
Lul	Lc	Lr	R	A
42	44	46	48	50
2nd Treatment				

51	53	55	57	59
Lul	Lc	Lr	O	
52	54	56	58	60
3rd Treatment				

61	63	65	67	69
Lc	Lr	Lul	R	A
62	64	66	68	70
3rd Treatment				

71	73	75	77	79
Lr	Lc	H	Lul	
72	74	76	78	80
1st Treatment				

81	83	85	87	89
Lr	Lc	H	Lul	
82	84	86	88	90
1st Treatment				

11  
**Rothamsted LEY-ARABLE 18th Year 1966**  
**FLA FOSTERS 1966**

111	113	115	117	119
		R H		
LC	Lu	Lr	H	Lr
112	114	116	118	120
1st Treatment				

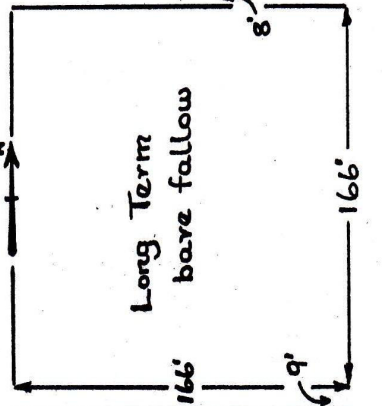

101	103	105	107	109
LC	A	Lr	Lu	R
102	104	106	108	110
11 WHEAT				

91	93	95	97	99
			R H	
Lr	Lu	Lr	H	
92	94	96	98	100
10 1st Treatment				

81	83	85	87	89
a:b R	c:r			
82	84	86	88	90
Lr	Lc	Sb	Lu	
9 2nd Treatment				

71	73	75	77	79
			a:b R	c:r
72	74	76	78	80
Lr	Lc	Sb	Lu	
8 2nd Treatment				

61	63	65	67	69
F:D	F:D	F:D	D:D	D:D
62	64	66	68	70
Lc	Lr	Lu	R	A
7 POTATOES				

51	53	55	57	59
a:b	R	c	a:b	a:b
52	54	56	58	60
Lr	Lc	Lr	Lr	A
6 WHEAT				

31	33	35	37	39
a:b	R	c:r	a:b	a:b
32	34	36	38	40
Lr	Lc	Lr	A	
4 BARLEY				

21	23	25	27	29
a:b	R	c:r	a:b	c:r
22	24	26	28	30
Lr	Lr	O	Lc	c:r
3 3rd Treatment				

41	43	45	47	49
F:F	F:D	D:D	D:D	F:D
42	44	46	48	50
Lu	Lc	Lr	R	A
5 POTATOES				

31	33	35	37	39
a:b	-3	2:3	-1	2:1
32	34	36	38	40
Cg	Lu	L	R	A
4 BARLEY				

21	23	25	27	29
a:b	R	c:r	a:b	c:r
22	24	26	28	30
Lr	Lr	O	Lc	c:r
3 3rd Treatment				

11	13	15	17	19
a:b	-3	2:3	-1	2:1
12	14	16	18	20
Cg	R	A	L	Lu
2 BARLEY				

1	3	5	7	9
		a:b	R	k:c
2	4	6	8	10
Lc	Lu	Lr	Lr	Lr
1 3rd Treatment				

- SYMBOLS**
- TREATMENT CROPS**  
 3 year Leys 1962 - cut.  
 Lc Grass/clover - No N.  
 Lr Grass With N.  
 Lu Lucerne  
 3 year Leys 1949-64  
 L Grazed ley  
 Cg Cut grass  
 3 years Arable "A"  
 H Hay Sb Sugarbeet  
 O oats
- TEST CROPS**  
 W WHEAT  
 P POTATOES  
 B BARLEY  
 Old Permanent Grass  
 & Reseeded Grass  
 Gc, Rc Without N } cut  
 Gr, Rn With N }



Rothamsted LEY-ARABLE 19th Year  
 FOSTERS 1967  
 FLA  
 N 1966  
 12

111	a	b	113	a	b	115	a	b	117	a	b	119	a	b		
												(R)				
Lc	Lu	Sb	Lu	Sb	Sb	Lu	Sb	Sb	Lu	Sb	Sb	Lu	Sb	Lu		
												112	114	116	118	120
												2nd Treatment				

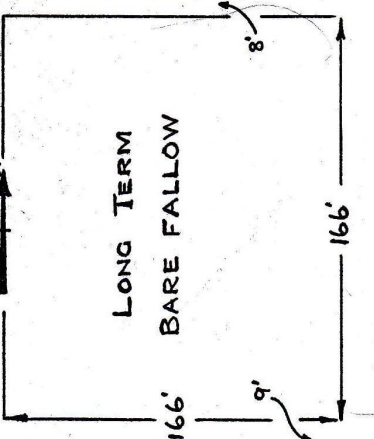

101	a	b	103	a	b	105	a	b	107	a	b	109	a	b					
												F	D	F	D	F	D	F	D
Lc	Lu	Sb	Lc	Lu	Sb	Lc	Lu	Sb	Lc	Lu	Sb	Lc	Lu	Sb					
												102	104	106	108	110			
												D F D F D F D							

91	a	b	93	a	b	95	a	b	97	a	b	99	a	b		
												(R)				
Ln	Lu	Lc	Sb	Ln	Lu	Lc	Sb	Ln	Lu	Lc	Sb	Ln	Lu	Lc		
												92	94	96	98	100
												2nd Treatment				

51	a	b	53	a	b	55	a	b	57	a	b	59	a	b					
												F	F	R	c	F	F	F	F
Lu	Lu	Lc	Ln	Lu	Lc	Ln	Lu	Lc	Ln	Lu	Lc	Ln	Lu	Lc					
												52	54	56	58	60			
												D F D F D D							

71	a	b	73	a	b	75	a	b	77	a	b	79	a	b		
												R	c	n		
Ln	Lc	O	Ln	Lc	O	Ln	Lc	O	Ln	Lc	O	Ln	Lc	O		
												72	74	76	78	80
												3rd Treatment				

61	a	b	63	a	b	65	a	b	67	a	b	69	a	b		
												(R)				
Lc	Lu	Lc	Lu	Lc	Lu	Lc	Lu	Lc	Lu	Lc	Lu	Lc	Lu	Lc		
												62	64	66	68	70
												3rd Treatment				

21	a	b	23	a	b	25	a	b	27	a	b	29	a	b		
												(R)				
Lu	Ln	Lu	Ln	Lu	Ln	Lu	Ln	Lu	Ln	Lu	Ln	Lu	Ln	Lu		
												22	24	26	28	30
												1st Treatment				

11	a	b	13	a	b	15	a	b	17	a	b	19	a	b		
												(R)				
Ln	H	H	Lc	H	H	Lc	H	H	Lc	H	H	Lc	H	H		
												12	14	16	18	20
												1st Treatment				

31	a	b	33	a	b	35	a	b	37	a	b	39	a	b		
												(R)				
Lu	Lc	Lu	Lc	Lu	Lc	Lu	Lc	Lu	Lc	Lu	Lc	Lu	Lc	Lu		
												32	34	36	38	40
												1st Treatment				

41	a	b	43	a	b	45	a	b	47	a	b	49	a	b		
												(R)				
Lu	Lc	Lu	Lc	Lu	Lc	Lu	Lc	Lu	Lc	Lu	Lc	Lu	Lc	Lu		
												42	44	46	48	50
												3rd Treatment				

21	a	b	23	a	b	25	a	b	27	a	b	29	a	b		
												(R)				
Lu	Ln	Lu	Ln	Lu	Ln	Lu	Ln	Lu	Ln	Lu	Ln	Lu	Ln	Lu		
												22	24	26	28	30
												1st Treatment				

71	a	b	73	a	b	75	a	b	77	a	b	79	a	b		
												(R)				
Lc	Lu	Lc	Lu	Lc	Lu	Lc	Lu	Lc	Lu	Lc	Lu	Lc	Lu	Lc		
												72	74	76	78	80
												3rd Treatment				

11	a	b	13	a	b	15	a	b	17	a	b	19	a	b		
												(R)				
Ln	H	H	Lc	H	H	Lc	H	H	Lc	H	H	Lc	H	H		
												12	14	16	18	20
												1st Treatment				

31	a	b	33	a	b	35	a	b	37	a	b	39	a	b		
												(R)				
Lu	Lc	Lu	Lc	Lu	Lc	Lu	Lc	Lu	Lc	Lu	Lc	Lu	Lc	Lu		
												32	34	36	38	40
												1st Treatment				

**SYMBOLS**  
 Treatment Crops.  
 3 year Leys. Cut:  
 Lc Grass/Clver, No N  
 Ln Grass with N  
 Lu Lucerne  
 3 years Arable A'(R)  
 H Hay Sb Sugarbeet  
 O Oats  
 (R) Long-term reseeded grass. Ploughed up for TEST crops.

**TEST CROPS**  
 W Wheat  
 P Potatoes  
 B Barley  
 Old Permanent & Reseeded Grass. Cut:  
 Ge, Rc No N  
 Gn, Rn with N

Rothamsted LEY-ARABLE 20th. Year FLA FOSTERS 1968 12

SYMBOLS

Treatment Crops  
3 year Leys, cut:

Lc Grass/clover, No N.  
Ln Grass with N  
Lu Lucerne.

3 years Arable A'(R)(G)  
H Hay Sb Sugarbeet  
O Oats

(G),(R) Permanent & Long-term reseeded grass ploughed up for TEST crops.

TEST CROPS

Sequence 1949 - 1969

(W) P B W\*  
(W\* 1968 only)

Sequence 1968 -

P\* W B

W Wheat, P Potatoes  
B Barley

Old Permanent (Highfield) & Reseeded Grass, cut:

Gc, Rc No nitrogen  
Gr, Rn With nitrogen.

91/b	93	95	97	99	101	103	105	107	109
ax/bx	ax/bx	ax/bx	ax/bx	ax/bx	ax/bx	ax/bx	ax/bx	ax/bx	ax/bx
2/3	2/3	2/3	2/3	2/3	2/3	2/3	2/3	2/3	2/3
Ln	Lu	Lc	O	O	Lc	A	Ln	Lu	R
92	94	96	98	100	102	104	106	108	110
ax/bx	ax/bx	ax/bx	ax/bx	ax/bx	ax/bx	ax/bx	ax/bx	ax/bx	ax/bx
2/3	2/3	2/3	2/3	2/3	2/3	2/3	2/3	2/3	2/3
Ln	Lu	Lc	O	O	Lc	A	Ln	Lu	R

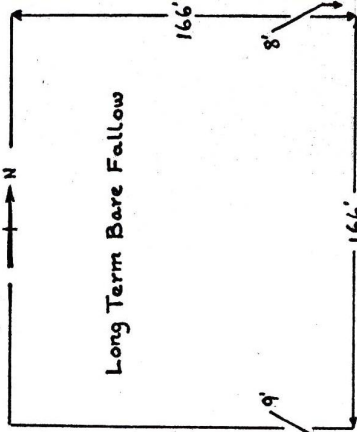

a/11/b	113	115	117	119
ax/bx	ax/bx	ax/bx	ax/bx	ax/bx
2/3	2/3	2/3	2/3	2/3
Lc	Lu	O	O	Ln
112	114	116	118	120
ax/bx	ax/bx	ax/bx	ax/bx	ax/bx
2/3	2/3	2/3	2/3	2/3
Ln	Lu	Lc	Ln	Lu

Numbering 7(a) to 9(b)4

71/b	73/b	75/b	77/b	79/b	81/b	83/b	85/b	87/b	89/b
ax/bx	ax/bx	ax/bx	ax/bx	ax/bx	ax/bx	ax/bx	ax/bx	ax/bx	ax/bx
2/3	2/3	2/3	2/3	2/3	2/3	2/3	2/3	2/3	2/3
Ln	Lc	AH	(R)	Lu	(R)	Ln	Lc	AH	Lu
72/b	74/b	76/b	78/b	80/b	82/b	84/b	86/b	88/b	90/b
ax/bx	ax/bx	ax/bx	ax/bx	ax/bx	ax/bx	ax/bx	ax/bx	ax/bx	ax/bx
2/3	2/3	2/3	2/3	2/3	2/3	2/3	2/3	2/3	2/3
Ln	Lc	AH	(R)	Lu	(R)	Ln	Lc	AH	Lu

61	63	65	67	69	70
ax/bx	ax/bx	ax/bx	ax/bx	ax/bx	ax/bx
2/3	2/3	2/3	2/3	2/3	2/3
Lc	Ln	Lu	(R)	A	WHEAT
62	64	66	68	70	71
ax/bx	ax/bx	ax/bx	ax/bx	ax/bx	ax/bx
2/3	2/3	2/3	2/3	2/3	2/3
Ln	Lc	Lu	(R)	A	WHEAT

51	53	55	57	59	60
ax/bx	ax/bx	ax/bx	ax/bx	ax/bx	ax/bx
2/3	2/3	2/3	2/3	2/3	2/3
Lu	Lc	Lc	Lc	AH	BARLEY
52	54	56	58	60	61
ax/bx	ax/bx	ax/bx	ax/bx	ax/bx	ax/bx
2/3	2/3	2/3	2/3	2/3	2/3
Lu	Lc	Lc	Lc	AH	BARLEY

a/1/b	3	5	7	9	11	13	15	17	19
ax/bx	ax/bx	ax/bx	ax/bx	ax/bx	ax/bx	ax/bx	ax/bx	ax/bx	ax/bx
2/3	2/3	2/3	2/3	2/3	2/3	2/3	2/3	2/3	2/3
D	F	D	D	R	D	F	D	F	D
Ln	A	Lu	Lu	Ln	Sb	Lc	Lc	Lu	Lu
2	4	6	8	10	12	14	16	18	20
ax/bx	ax/bx	ax/bx	ax/bx	ax/bx	ax/bx	ax/bx	ax/bx	ax/bx	ax/bx
2/3	2/3	2/3	2/3	2/3	2/3	2/3	2/3	2/3	2/3
D	F	D	F	F	D	F	D	F	D
Ln	Sb	Lc	Lc	Ln	Sb	Lc	Lc	Ln	Ln

a/21/b	23	25	27	29	30
ax/bx	ax/bx	ax/bx	ax/bx	ax/bx	ax/bx
2/3	2/3	2/3	2/3	2/3	2/3
F	D	F	D	F	D
Ln	Lr	A	Lc	Lc	Sb
22	24	26	28	30	32
ax/bx	ax/bx	ax/bx	ax/bx	ax/bx	ax/bx
2/3	2/3	2/3	2/3	2/3	2/3
D	F	D	F	D	F
Ln	Lc	Lc	Sb	Sb	Lr

a/1	43	45	47	49
ax/bx	ax/bx	ax/bx	ax/bx	ax/bx
2/3	2/3	2/3	2/3	2/3
a	b	c	d	e
Lu	Lc	Ln	(R)	A
42	44	46	48	50
ax/bx	ax/bx	ax/bx	ax/bx	ax/bx
2/3	2/3	2/3	2/3	2/3
a	b	c	d	e
a	b	c	d	e

Rothamsted LEY - ARABLE 21st Year 1969 10  
 69/R/RN/2 FOSTERS 1969 10  
 1111 - 1208

Sub-plots 0911 - 1008

Example of numbering sub-plots in potatoes

Wheat: Joss Cambier sown: 14th Oct.

in 1967 6A

in 1968 6A

in 1966 6A

091 K 2 F-D PK 1 K 1	092 K 2 F-D PK 1 K 1	093 K 2 F-D PK 1 K 1	094 K 2 F-D PK 1 K 1	095 K 2 F-D PK 1 K 1	096 K 2 F-D PK 1 K 1	097 K 2 F-D PK 1 K 1	098 K 2 F-D PK 1 K 1	099 K 2 F-D PK 1 K 1
101 K 2 F-D PK 1 K 1	102 K 2 F-D PK 1 K 1	103 K 2 F-D PK 1 K 1	104 K 2 F-D PK 1 K 1	105 K 2 F-D PK 1 K 1	106 K 2 F-D PK 1 K 1	107 K 2 F-D PK 1 K 1	108 K 2 F-D PK 1 K 1	109 K 2 F-D PK 1 K 1

101 K 2 F-D PK 1 K 1	102 K 2 F-D PK 1 K 1	103 K 2 F-D PK 1 K 1	104 K 2 F-D PK 1 K 1	105 K 2 F-D PK 1 K 1	106 K 2 F-D PK 1 K 1	107 K 2 F-D PK 1 K 1	108 K 2 F-D PK 1 K 1	109 K 2 F-D PK 1 K 1
----------------------------------	----------------------------------	----------------------------------	----------------------------------	----------------------------------	----------------------------------	----------------------------------	----------------------------------	----------------------------------

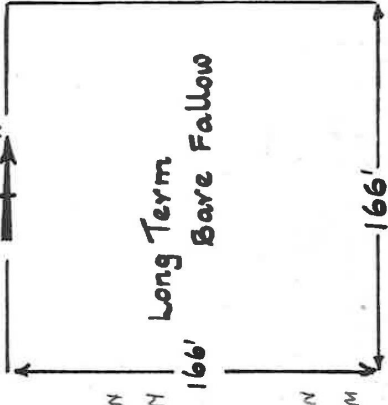

111 K 2 F-D PK 1 K 1	112 K 2 F-D PK 1 K 1	113 K 2 F-D PK 1 K 1	114 K 2 F-D PK 1 K 1	115 K 2 F-D PK 1 K 1	116 K 2 F-D PK 1 K 1	117 K 2 F-D PK 1 K 1	118 K 2 F-D PK 1 K 1	119 K 2 F-D PK 1 K 1
----------------------------------	----------------------------------	----------------------------------	----------------------------------	----------------------------------	----------------------------------	----------------------------------	----------------------------------	----------------------------------

120 K 2 F-D PK 1 K 1	121 K 2 F-D PK 1 K 1	122 K 2 F-D PK 1 K 1	123 K 2 F-D PK 1 K 1	124 K 2 F-D PK 1 K 1
----------------------------------	----------------------------------	----------------------------------	----------------------------------	----------------------------------

071 K 2 F-D PK 1 K 1	072 K 2 F-D PK 1 K 1	073 K 2 F-D PK 1 K 1	074 K 2 F-D PK 1 K 1	075 K 2 F-D PK 1 K 1	076 K 2 F-D PK 1 K 1	077 K 2 F-D PK 1 K 1	078 K 2 F-D PK 1 K 1	079 K 2 F-D PK 1 K 1
----------------------------------	----------------------------------	----------------------------------	----------------------------------	----------------------------------	----------------------------------	----------------------------------	----------------------------------	----------------------------------

061 K 2 F-D PK 1 K 1	062 K 2 F-D PK 1 K 1	063 K 2 F-D PK 1 K 1	064 K 2 F-D PK 1 K 1	065 K 2 F-D PK 1 K 1	066 K 2 F-D PK 1 K 1	067 K 2 F-D PK 1 K 1	068 K 2 F-D PK 1 K 1	069 K 2 F-D PK 1 K 1
----------------------------------	----------------------------------	----------------------------------	----------------------------------	----------------------------------	----------------------------------	----------------------------------	----------------------------------	----------------------------------

051 K 2 F-D PK 1 K 1	052 K 2 F-D PK 1 K 1	053 K 2 F-D PK 1 K 1	054 K 2 F-D PK 1 K 1	055 K 2 F-D PK 1 K 1	056 K 2 F-D PK 1 K 1	057 K 2 F-D PK 1 K 1	058 K 2 F-D PK 1 K 1	059 K 2 F-D PK 1 K 1
----------------------------------	----------------------------------	----------------------------------	----------------------------------	----------------------------------	----------------------------------	----------------------------------	----------------------------------	----------------------------------

081 K 2 F-D PK 1 K 1	082 K 2 F-D PK 1 K 1	083 K 2 F-D PK 1 K 1	084 K 2 F-D PK 1 K 1	085 K 2 F-D PK 1 K 1	086 K 2 F-D PK 1 K 1	087 K 2 F-D PK 1 K 1	088 K 2 F-D PK 1 K 1	089 K 2 F-D PK 1 K 1
----------------------------------	----------------------------------	----------------------------------	----------------------------------	----------------------------------	----------------------------------	----------------------------------	----------------------------------	----------------------------------

041 K 2 F-D PK 1 K 1	042 K 2 F-D PK 1 K 1	043 K 2 F-D PK 1 K 1	044 K 2 F-D PK 1 K 1	045 K 2 F-D PK 1 K 1	046 K 2 F-D PK 1 K 1	047 K 2 F-D PK 1 K 1	048 K 2 F-D PK 1 K 1	049 K 2 F-D PK 1 K 1
----------------------------------	----------------------------------	----------------------------------	----------------------------------	----------------------------------	----------------------------------	----------------------------------	----------------------------------	----------------------------------

021 K 2 F-D PK 1 K 1	022 K 2 F-D PK 1 K 1	023 K 2 F-D PK 1 K 1	024 K 2 F-D PK 1 K 1	025 K 2 F-D PK 1 K 1	026 K 2 F-D PK 1 K 1	027 K 2 F-D PK 1 K 1	028 K 2 F-D PK 1 K 1	029 K 2 F-D PK 1 K 1
----------------------------------	----------------------------------	----------------------------------	----------------------------------	----------------------------------	----------------------------------	----------------------------------	----------------------------------	----------------------------------

001 K 2 F-D PK 1 K 1	002 K 2 F-D PK 1 K 1	003 K 2 F-D PK 1 K 1	004 K 2 F-D PK 1 K 1	005 K 2 F-D PK 1 K 1	006 K 2 F-D PK 1 K 1	007 K 2 F-D PK 1 K 1	008 K 2 F-D PK 1 K 1	009 K 2 F-D PK 1 K 1
----------------------------------	----------------------------------	----------------------------------	----------------------------------	----------------------------------	----------------------------------	----------------------------------	----------------------------------	----------------------------------

001 K 2 F-D PK 1 K 1	002 K 2 F-D PK 1 K 1	003 K 2 F-D PK 1 K 1	004 K 2 F-D PK 1 K 1	005 K 2 F-D PK 1 K 1	006 K 2 F-D PK 1 K 1	007 K 2 F-D PK 1 K 1	008 K 2 F-D PK 1 K 1	009 K 2 F-D PK 1 K 1
----------------------------------	----------------------------------	----------------------------------	----------------------------------	----------------------------------	----------------------------------	----------------------------------	----------------------------------	----------------------------------

001 K 2 F-D PK 1 K 1	002 K 2 F-D PK 1 K 1	003 K 2 F-D PK 1 K 1	004 K 2 F-D PK 1 K 1	005 K 2 F-D PK 1 K 1	006 K 2 F-D PK 1 K 1	007 K 2 F-D PK 1 K 1	008 K 2 F-D PK 1 K 1	009 K 2 F-D PK 1 K 1
----------------------------------	----------------------------------	----------------------------------	----------------------------------	----------------------------------	----------------------------------	----------------------------------	----------------------------------	----------------------------------

001 K 2 F-D PK 1 K 1	002 K 2 F-D PK 1 K 1	003 K 2 F-D PK 1 K 1	004 K 2 F-D PK 1 K 1	005 K 2 F-D PK 1 K 1	006 K 2 F-D PK 1 K 1	007 K 2 F-D PK 1 K 1	008 K 2 F-D PK 1 K 1	009 K 2 F-D PK 1 K 1
----------------------------------	----------------------------------	----------------------------------	----------------------------------	----------------------------------	----------------------------------	----------------------------------	----------------------------------	----------------------------------

001 K 2 F-D PK 1 K 1	002 K 2 F-D PK 1 K 1	003 K 2 F-D PK 1 K 1	004 K 2 F-D PK 1 K 1	005 K 2 F-D PK 1 K 1	006 K 2 F-D PK 1 K 1	007 K 2 F-D PK 1 K 1	008 K 2 F-D PK 1 K 1	009 K 2 F-D PK 1 K 1
----------------------------------	----------------------------------	----------------------------------	----------------------------------	----------------------------------	----------------------------------	----------------------------------	----------------------------------	----------------------------------

in 1967 6A  
 in 1968 6A  
 in 1966 6A